

WELLTEC



TOTAL AUXILIARY EQUIPMENT

From Scratch to Finish • For your IMM production





02-05

Water Chiller



- WATER / AIR COOLED CHILLER (STD TYPE)
- WATER / AIR COOLED CHILLER (ECO TYPE)

06-09

Autoloader



- AUTOLOADER - SINGLE TYPE
- AUTOLOADER - SEPARATE TYPE
- AUTOLOADER - HIGH POWER
- AUTOLOADER - MULTI STATION

10-20

Dryer and Dehumidifier



- HOPPER DRYER - STD TYPE
- HOPPER DRYER - ECO TYPE
- HOPPER DRYER - ACCESSORY
- HOPPER DRYER - EU TYPE
- HONEYCOMB DEHUMIDIFIER
- 2 IN 1 DRY-DEHUMIDIFIER
- 3 IN 1 DRY-LOAD-DEHUMIDIFIER
- MOLD DEHUMIDIFIERS

21-24

Mold Temperature Controller



- M.T.C. (WATER / OIL TYPE)
- M.T.C. (HIGH TEMP. WATER TYPE 160-180C)
- M.T.C. (HIGH TEMP. OIL TYPE 300C)
- M.T.C. (MULTIPLE)

25-35

Crusher and Granulator



- MEDIUM SPEED GRANULATOR
- LOW SPEED GRANULATOR
- SCREENLESS LOW SPEED GRANULATOR
- SOUNDPROOF CRUSHER WITH COLLECTOR
- CLAW / FLAT TYPE CRUSHER
- V TYPE CRUSHER
- FLAKE TYPE CRUSHER
- GB SERIES CRUSHER
- AUTO COLLECTING SYSTEM
- AUTO POWDER SIFTING DEVICE

36-42

Mixer and Blender



- VERTICAL MIXER - STD TYPE
- VERTICAL MIXER - EU TYPE
- VOLUMETRIC MIXER - DUAL SILOS
- VOLUMETRIC DOSER (SINGLE / MULTIPLE)
- GRAVIMETRIC BLENDER
- VERTICAL BLENDER

CONTENTS

WATER / AIR COOLED CHILLER (STD TYPE)

FEATURE:

- With the combination of advanced compressors, high efficient shell and tube condensers/finned condensers and shell and tube evaporators, excellent cooling, quiet with low electric consumption.
- Advanced microcomputer LCD chiller controller with water temperature accuracy of 3°C to 50°C.
- Current overload protection, high and low pressure protection system and electronic time delay, and an abnormal visual display system.
- Optional for single compressor, double compressor, three compressor and four compressor combinations. Independent system to enhance high energy efficiency.
- Optional RS485 communication function to realize automatic remote management.



WT-CHL-5W-R2



WT-CHL-5A-R2

SPECIFICATIONS

Model	Unit	WT-CHL-1A-R2	WT-CHL-2A-R2	WT-CHL-3W-R2	WT-CHL-5W-R2	WT-CHL-6W-R2	WT-CHL-8W-R2	WT-CHL-10W-R2	WT-CHL-12W-R2	WT-CHL-15W-R2	
		WT-CHL-3A-R2	WT-CHL-5A-R2	WT-CHL-6A-R2	WT-CHL-8A-R2	WT-CHL-10A-R2	WT-CHL-12A-R2	WT-CHL-15A-R2			
Water Cooling Capacity	KW	3.45	6.25	10.5	16	19.6	26.5	32.1	41.2	51.7	
	KCAL/H	2967	5375	9030	13760	16856	22790	27606	35432	44462	
Air Cooling Capacity	KW	3.42	6.2	8.6	14.9	17.2	23	29.4	37	46.5	
	KCAL/H	2941.2	5332	7396	12814	14792	19780	25284	31820	39990	
Compressor	Input Power	KW	0.75	1.5	2.2	3.75	4.5	6x1	3.75x2	4.5x2	3.75x3
	Rated Power	HP	1	2	3	5	6	8x1	5x2	6x2	5x3
Power		1PH-220V/50HZ			3PH-380V/50HZ (200V/220V/415V 50HZ/60HZ)						
Evaporator	Type	Water Tank With Coil			Shell And Tube						
	Pipe Diameter	INCH	1"	1"	1"	1"	1"	2"	2"	2"	2.5"
Refrigerant	Type	R22									
	Quantity	KG	1.6	1.8	2	2	2.5	4	5	5	7.5
Condenser (water chiller)	Type	Shell and Tube Condenser									
	Pipe Diameter	INCH			1"	1"	1"	1.5"	1.5"	1.5"	2"
Cooling Water Flow	M ³ /H	0.476	0.908	1.36	2.22	2.6	3.95	4.42	5.03	7.1	
Condenser (air chiller)	Type	Finned Copper Tube + Low Noise Outer Rotor Fan									
	Fan Power	W	90x1	170x1	180x1	180x2	180x2	420x2	420x2	420x2	800x2
Water Tank Capacity	LITER	20	25	40	45	45	80	80	80	100	
Pump	Power	KW	0.37	0.37	0.37	0.75	0.75	1.5	1.5	1.5	2.2
		HP	0.5	0.5	0.5	1	1	2	2	2	3
	Distance	M	23	23	23	35	35	15	15	15	16
	Flow Rate	L/MIN	100	100	100	110	110	360	360	360	360
Safety Protection		High And Low Pressure Protection, Overload Protection, Over Temperature Protection, Phase Sequence Protection, etc.									
Dimensions(L*W*H)	Water Cooled	MM			1080*640*986	1080*640*986	1080*640*986	1270*650*1413	1270*650*1413	1270*650*1413	1470*750*1413
	Air Cooled	MM	800*490*865	800*565*1025	960*630*1025	1280*680*1225	1280*680*1225	1550*850*1508	1550*850*1508	1550*850*1508	1850*1000*1600

Note:

1. Cooling capacity: chilled water inlet and outlet temperature of 12°C / 7°C, cooling water inlet and outlet temperature of 30°C / 35°C.
2. Working condition: chilled water temperature range is from 5°C to 35°C. Temperature difference between inlet and outlet of chilled water is from 3°C to 8 °C. Cooling water temperature range is from 18°C to 37°C. Temperature difference between inlet and outlet of cooling water is from 3.5°C to 10°C. We reserve the right to modify above information without prior notice.

WATER / AIR COOLED CHILLER (ECO TYPE)

FEATURE:

- Advanced hermetic scroll compressor with lower noise and less vibration.
- Environment-friendly refrigerant R407C, R134A, R410A. No harm to the ozone field.
- High-performance electrical appliances ensure stable running of the machine.
- Advanced stainless steel heat preservation water tank and piping system to ensure pure water and handy for cleaning and maintenance.
- Cooling capacity range from 2KW-2500KW. Various models can fully meet the demands of industrial production.
- European designed exterior with electrostatic spray coating.



WT-CHL-5A-R7

SPECIFICATIONS

Model	Unit	WT-CHL-3W-R7	WT-CHL-5W-R7	WT-CHL-6W-R7	WT-CHL-8W-R7	WT-CHL-10W-R7	WT-CHL-12W-R7	
		WT-CHL-3W-R0	WT-CHL-5W-R0	WT-CHL-6W-R0	WT-CHL-8W-R0	WT-CHL-10W-R0	WT-CHL-12W-R0	
Cooling Capacity	KW	10.5	16	19.6	26.5	32.1	41.2	
	KCAL/H	9030	13760	16856	22790	27606	35432	
Compressor	Input Power	KW	2.2	3.75	4.5	6	3.75x2	4.5x2
	Rated Power	HP	3	5	6	8	5x2	6x2
Power		3PH-380V/50HZ (200V/220V/415V/460V 50HZ/60HZ)						
Evaporator	Type	Shell And Tube						
	Pipe Diameter	Inch	1"	1"	1"	2"	2"	2"
Refrigerant	Type	R407C (R410A)						
	Control Method	Capillary Tube			[Capillary] Expansion Valve			
Condenser	Type	Shell Condenser						
	Pipe Diameter	Inch	1"	1"	1"	1.5"	1.5"	1.5"
Cooling Water Flow	M ³ /H	1.36	2.22	2.6	3.95	4.42	5.03	
Water Tank Capacity	LITER	40	45	45	80	80	80	
Pump	Power	KW	0.37	0.75	0.75	1.5	1.5	1.5
		HP	0.5	1	1	2	2	2
	Distance	M	23	35	35	15	15	15
	Flow Rate	L/MIN	100	110	110	360	360	360
Safety Protection		High and Low Pressure Protection, Overload Protection, Over Temperature Protection, Phase Sequence Protection, etc.						
Dimensions [LxWxH]	MM	1080x640x986	1080x640x986	1080x640x986	1270x650x1413	1270x650x1413	1270x650x1413	
Weight	KG	148	209	215	300	319	430	

Note:

1. Cooling capacity: chilled water inlet and outlet temperature of 12°C / 7°C, cooling water inlet and outlet temperature of 30°C / 35°C.
 2. Working condition: chilled water temperature range is from 5°C to 35°C. Temperature difference between inlet and outlet of chilled water is from 3°C to 8 °C. The ambient temperature is not higher than 35°C.
- We reserve the right to modify above information without prior notice.

SPECIFICATIONS

Model	Unit	WT-CHL-15W-R7	WT-CHL-20W-R7	WT-CHL-25W-R7	WT-CHL-30W-R7	WT-CHL-40W-R7	WT-CHL-50W-R7	
		WT-CHL-15W-R0	WT-CHL-20W-R0	WT-CHL-25W-R0	WT-CHL-30W-R0	WT-CHL-40W-R0	WT-CHL-50W-R0	
Cooling Capacity	KW	51.7	66.3	81.2	108	131	162.4	
	KCAL/H	44462	57018	69832	92880	112660	139664	
Compressor	Input Power	KW	3.75x3	7.5x2	9x2	11x2	18x2	
	Rated Power	HP	7.5x2	10x2	12.5x2	15x2	25x2	
Power		3PH-380V/50HZ [200V/220V/415V/460V 50HZ/60HZ]						
Evaporator	Type	Shell And Tube						
	Pipe Diameter	INCH	2.5"	2.5"	3"	3"	4"	4"
Refrigerant	Type	R407C (R410A)						
	Control Method	[Capillary] Expansion Valve						
Condenser	Type	Shell Condenser						
	Pipe Diameter	INCH	2"	2"	2.5"	2.5"	3"	3"
Cooling Water Flow	M ³ /H	7.1	8.84	10.06	13.6	17.75	21.9	
Water Tank Capacity	LITER	100	150	260	260	390	390	
Pump	Power	KW	2.2	2.2	4	4	5.5	7.5
		HP	3	3	5	5	7.5	10
	Distance	M	16	16	16	16	16	18
	Flow Rate	L/MIN	360	360	700	700	700	800
Safety Protection		High and Low Pressure Protection, Overload Protection, Over Temperature Protection, Phase Sequence Protection, etc.						
Dimensions (LxWxH)	MM	1470x750x1413	1880x880x1650	1880x880x1650	2050x1000x1730	2050x1000x1730	2190x1150x1840	
Weight	KG	475	633	754	897	1200	1250	

Note:
 1. Cooling capacity: chilled water inlet and outlet temperature of 12°C / 7°C, cooling water inlet and outlet temperature of 30°C / 35°C.
 2. Working condition: chilled water temperature range is from 5°C to 35°C. Temperature difference between inlet and outlet of chilled water is from 3°C to 8 °C.
 The ambient temperature is not higher than 35°C.
 We reserve the right to modify above information without prior notice.

Model	Unit	WT-CHL-1A-R7	WT-CHL-2A-R7	WT-CHL-3A-R7	WT-CHL-5A-R7	WT-CHL-6A-R7	WT-CHL-8A-R7	WT-CHL-10A-R7	
		WT-CHL-1A-R0	WT-CHL-2A-R0	WT-CHL-3A-R0	WT-CHL-5A-R0	WT-CHL-6A-R0	WT-CHL-8A-R0	WT-CHL-10A-R0	
Cooling Capacity	KW	3.42	6.2	8.6	14.9	17.2	23	29.4	
	KCAL/H	2941.2	5332	7396	12814	14792	19780	25284	
Compressor	Input Power	KW	0.75	1.5	2.2	3.75	4.5	6	3.75x2
	Rated Power	HP	1	2	3	5	6	8	5x2
Power		1PH-220V/50HZ			3PH-380V/50HZ [200V/220V/415V/460V 50HZ/60HZ]				
Evaporator	Type	Water Tank With Coil			Shell And Tube				
	Pipe Diameter	INCH	1"	1"	1"	1"	2"	2"	
Refrigerant	Type	R407C (R410A)							
	Control Method	Capillary Tube				[Capillary] Expansion Valve			
Cooling Water Flow	M ³ /H	0.476	0.908	1.36	2.22	2.6	3.95	4.42	
Condenser	Type	Finned Copper Tube + Low Noise Outer Rotor Fan							
	Fan Power	W	90x1	170x1	180x1	180x2	180x2	420x2	420x2
Water Tank Capacity	LITER	20	25	40	45	45	80	80	
Pump	Power	KW	0.37	0.37	0.37	0.75	0.75	1.5	1.5
		HP	0.5	0.5	0.5	1	1	2	2
	Distance	M	23	23	23	35	35	15	15
	Flow Rate	L/MIN	100	100	100	110	110	360	360
Safety Protection		High and Low Pressure Protection, Overload Protection, Over Temperature Protection, Phase Sequence Protection, etc.							
Dimensions (LxWxH)	MM	800x490x865	800x565x1025	960x630x1026	1280x680x1225	1280x680x1225	1550x850x1508	1550x850x1508	
Weight	KG	83	101	154	227	234	400	429	

Note:
 1. Cooling capacity: chilled water inlet and outlet temperature of 12°C / 7°C, cooling water inlet and outlet temperature of 30°C / 35°C.
 2. Working condition: chilled water temperature range is from 5°C to 35°C. Temperature difference between inlet and outlet of chilled water is from 3°C to 8 °C.
 The ambient temperature is not higher than 35°C.
 We reserve the right to modify above information without prior notice.

SPECIFICATIONS

Model	Unit	WT-CHL-12A-R7	WT-CHL-15A-R7	WT-CHL-20A-R7	WT-CHL-25A-R7	WT-CHL-30A-R7	WT-CHL-40A-R7	WT-CHL-50A-R7	
		WT-CHL-12A-R0	WT-CHL-15A-R0	WT-CHL-20A-R0	WT-CHL-25A-R0	WT-CHL-30A-R0	WT-CHL-40A-R0	WT-CHL-50A-R0	
Cooling Capacity	KW	37	46.5	62	74.1	92.7	122.3	147.3	
	KCAL/H	31820	39990	53320	63726	79722	105178	126678	
Compressor	Input Power	4.5x2	3.75x3	7.5x2	9x2	11x2	15x2	18.8x2	
	Rated Power	6x2	5x3	10x2	12.5x2	15x2	20x2	25x2	
Power	3PH-380V/50HZ (200V/220V/415V/460V 50HZ/60HZ)								
Evaporator	Type	Shell And Tube							
	Pipe Diameter	INCH	2"	2.5"	2.5"	3"	3"	4"	4"
Refrigerant	Type	R407C (R410A)							
	Control Method	[Capillary] Expansion Valve							
Cooling Water Flow	M ³ /H	5.03	7.1	8.84	10.06	13.6	17.75	21.9	
Condenser	Type	Finned Copper Tube + Low Noise Outer Rotor Fan							
	Fan Power	W	420x2	800x2	420x3	800x3	800x3	420x6	800x6
Water Tank Capacity	LITER	80	100	150	210	210	380	420	
Pump	Power	KW	1.5	2.2	2.2	4	4	5.5	7.5
		HP	2	3	3	5	5	7.5	10
	Distance	M	15	16	16	16	16	16	18
	Flow Rate	L/MIN	360	360	360	700	700	700	800
Safety Protection	High and Low Pressure Protection, Overload Protection, Over Temperature Protection, Phase Sequence Protection, etc.								
Dimensions (LxWxH)	MM	1550x850x1508	1850x1000x1600	2150x1000x1780	2400x1150x1800	2600x1150x1900	2300x2000x1800	2800x2100x1960	
Weight	KG	530	559	835	900	1080	1125	1380	

Note:

- Cooling capacity: chilled water inlet and outlet temperature of 12°C / 7°C, cooling water inlet and outlet temperature of 30°C / 35°C.
- Working condition: chilled water temperature range is from 5°C to 35°C. Temperature difference between inlet and outlet of chilled water is from 3°C to 8 °C. The ambient temperature is not higher than 35°C.

We reserve the right to modify above information without prior notice.

AUTOLOADER (SINGLE TYPE)

FEATURE:

- With small footprint and low weight, can place onto other machines or containers directly for auto loading.
- Wire-controlled controller, easy to use.
- Alarm for overload and material shortage.
- Material contact parts are made of stainless steel to ensure raw materials not to be polluted during conveying.
- 300G machine adopts high-speed carbon brush motor, small size and strong suction, suitable for conveying new materials.
- 400G machine adopts induction high-pressure motor, with the function of reversing and automatically removing dust in low noise.

SPECIFICATIONS

Model		WT-SAL-300G	WT-SAL-400G
Motor	Type	Carbon Brush	Induction
	Specification	1.1KW/1.3HP 1Φ	0.75KW/1HP 3Φ
Conveying Capacity (KG/H)		300	330
Loading Distance (M)		3.5	4
Static Wind Pressure (MM/H ₂ O)		1300	1400
Reservoir Volume (L)		7.5	7.5
Conveying Tube Inner Diameter (MM)		Φ38	Φ38
Specification Of The Attached Hoses (MM)		Φ38mmx4m 1Pc	Φ38mmx4m 1Pc
Dimensions (LxWxH) (CM)		42x34x57	46x39x66
Approx. Net Weight (KG)		13.5	26

Conveying capacity and loading distance are tested by ABS material. Actual data may differ by plastic proportions, shapes, loading lengths and heights, pipe conditions and parameter settings. For processing hot materials, heat-resistant pipes with 160 °C are necessary.

We reserve the right to modify above information without prior notice.



WT-SAL-300G



WT-SAL-400G

AUTOLOADER (SEPARATE TYPE)

FEATURE:

- Main machine separated from the hopper, easy and safe to operate.
- Independent filter for easy cleaning.
- Stainless steel hopper to ensure raw materials not to be polluted during transportation.
- Microcomputer operation control program.
- Alarm for overload and material shortage.
- 700G machine adopts high-speed carbon brush motor, small size and strong suction, suitable for conveying new materials.
- 800G/800G2 with induction type high pressure motor, with low noise and long service time.
- 800G/800G2 are with reverse running and auto matically dust removing function.



WT-SAL-700G

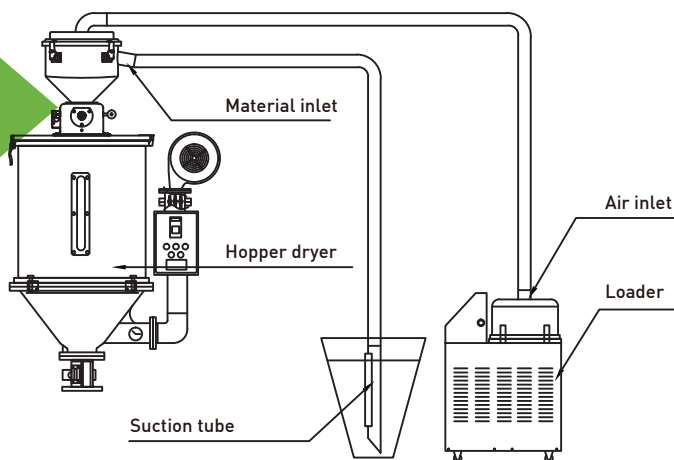

WT-SAL-800G

SPECIFICATIONS

Model		WT-SAL-700G	WT-SAL-800G	WT-SAL-800G2
Motor	Type	Carbon Brush	Induction	Induction
	Specification	1.1KW/1.3HP 1φ	1.1KW/1.5HP 3φ	1.5KW/2HP 3φ
Conveying Capacity (KG/H)		310	450	500
Loading Distance (M)		4	4	5
Static Wind Pressure (MM/H:0)		1550	1800	2400
Reservoir Volume (L)		7.5	7.5	7.5
Conveying Tube Inner Diameter (MM)		φ38	φ38	φ38
Specification Of The Attached Hoses (MM)		φ38mmx8m 1Pc	φ38mmx8m 1Pc	φ38mmx10m 1Pc
Dimension (CM)	Main Frame	37x30x56	45x38x67	45x38x67
	Hopper	38x28x45		
Approx. Net Weight (KG)		26	48	48.5

Conveying capacity and loading distance are tested by ABS material. Actual data may differ by plastic proportions, shapes, loading lengths and heights, pipe conditions and parameter settings. For processing hot materials, heat-resistant pipes with 160 °C are necessary.

We reserve the right to modify above information without prior notice.

AUTOLOADER (HIGH POWER)

FEATURE:

- Tailor- made for large amount of materials conveying, and especially long conveying distance and crushed materials and powder.
- High-power motor with enlarged hose and hopper.
- Reversing and automatically removing dust.
- Advanced LCD microcomputer controller with adjustable parameters, intuitive display and convenient operation.
- Unique cyclone barrel and large dust isolation. Collection system with advanced design to enhance easy maintenance.
- ≥ 5 HP equipped with vacuum breaking valve as standard to prevent frequent start and stop, so prolong the service life of the motor.
- Optional RS485 communication function to realize remote automatic management.



WT-XAL-5HP

SPECIFICATIONS

Model	WT-XAL-1.5HP	WT-XAL-2HP	WT-XAL-3HP	WT-XAL-5HP	WT-XAL-7.5HP	WT-XAL-10HP	WT-XAL-15HP
Motor (HP/KW)	1.5/1.1	2/1.5	3/2.2	5/3.75	7.5/5.5	10/7.5	15/11
Conveying Capacity (KG/H)	450	500	590	820	1000	1300	1500
Loading Distance (M)	5	5	5	5	6	6	6
Static Wind Pressure (MM/H ₂ O)	2800	2800	2800	3200	4200	4500	4500
Storage Tank Volume (L)	7.5	7.5	12	24	30	30	30
Conveying Tube Inner Diameter (MM)	Φ38	Φ38	Φ51	Φ51	Φ63	Φ63	Φ63
Specification Of The Attached Hoses (MM)	Φ38mmx8m 1Pc	Φ38mmx8m 1Pc	Φ51mmx10m 1Pc	Φ51mmx10m 1Pc	Φ63mmx12m 1Pc	Φ63mmx12m 1Pc	Φ63mmx12m 1Pc
Dimensions (DxWxH) (CM)	Main Frame	50x42x109			69x52x144		99x85x142
	Hopper	38x28x45	38x28x45	43x33x58	43x33x69	43x33x83	
Approx. Net Weight (KG)	56	56	68	81	137	152	168

Conveying capacity and loading distance are tested by ABS material.
Actual data may differ by plastic proportions, shapes, loading lengths and heights, pipe conditions and parameter settings.
For processing hot materials, heat-resistant pipes with 160 °C are necessary.

We reserve the right to modify above information without prior notice.

AUTOLOADER (MULTI STATION)

FEATURE:

- One main machine controls several hoppers to save cost and space. Vacuum hoppers and sensor hoppers are alternative.
- Especially for drying and feeding integrated system.
- Equipped with automatic spray cleaning dust removal device to clean the dust on the filter automatically.
- Advanced LCD microcomputer controller with adjustable parameters, intuitive display and convenient operation.
- Unique cyclone barrel and large dust isolation.
- Collection system with advanced design to enhance easy maintenance.
- ≥5HP equipped with vacuum breaking valve as standard to prevent frequent start and stop, so prolong the service life of the motor.
- Optional RS485 communication function to realize remote automatic management.



WT-MAL-3

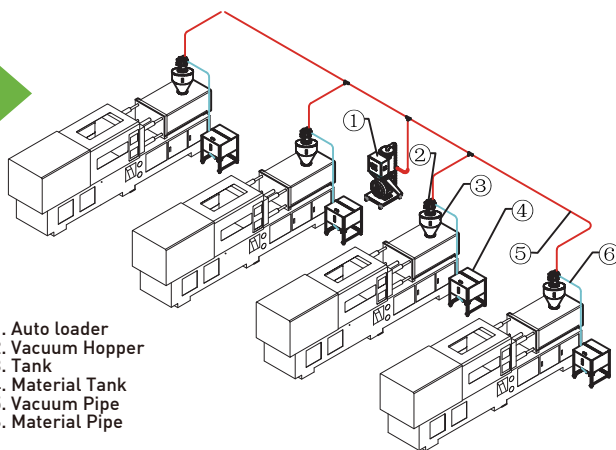

1. Auto loader
2. Vacuum Hopper
3. Tank
4. Material Tank
5. Vacuum Pipe
6. Material Pipe

SPECIFICATIONS

Model	WT-MAL-2	WT-MAL-3	WT-MAL-4
Motor [HP/KW]	1.5/1.1	2/1.5	3/2.2
Conveying Capacity [KG/H]	440	500	590
Loading Distance [M]	4	4	5
Static Wind Pressure (MM/H ₂ O)	2400	2400	2400
Storage Tank Volume [L]	7.5x2	7.5x3	12x4
Conveying Tube Inner Diameter (MM)	φ38	φ38	φ38
Specification Of The Attached Hoses (MM)	φ38mmx5m 4Pcs	φ38mmx5m 6Pcs	φ38mmx5m 4Pcs φ51mmx5m 4Pcs
Dimensions (CM)	50x55x109		
Approx. Net Weight [KG]	68	82	113

Conveying capacity and loading distance are tested by ABS material. Actual data may differ by plastic proportions, shapes, loading lengths and heights, pipe conditions and parameter settings. For processing hot materials, heat-resistant pipes with 160 °C are necessary.

We reserve the right to modify above information without prior notice



Vacuum Hopper



Sensor Hopper

LOADER ACCESSORIES



Suction Tube
Standard item for hopper loaders, made by stainless steel, easy to use.



Filter
To avoid motor damage by powder in material loading and keep long term running.

HOPPER DRYER (STD TYPE)

FEATURE:

- Adopting high-performance hot air diffusion device design to ensure uniform temperature and improve drying efficiency.
- The barrel and internal parts are made of stainless steel to ensure raw materials not to be polluted.
- Precision die cast aluminum shell with smooth surface and good thermal insulation performance.
- Electric barrel with bending design to avoid combustion caused by raw materials powder accumulation at the bottom.
- LCD microcomputer controller with temperature control accuracy of $\pm 0.1^{\circ}\text{C}$.
- 24-hour automatic timing device to realize automatic operation of the whole machine by appointment.
- Optional for high temperature type and double-layer insulation type.
- Optional for hot air recovery system, more energy-saving and environmentally friendly.
- Optional for RS485 communication to realize remote automatic control.



WT-HDR50



WT-HDDR50

Double layer insulation type
Hot air recycler optional

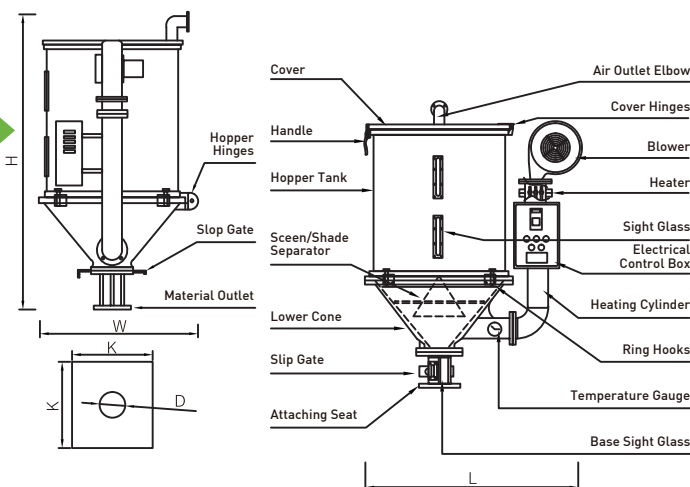

SPECIFICATIONS

Model	Capacity (KG)	Heating Power (KW)	Blower (W)	Voltage (V)	Dimensions (MM)	Base Size (KxKxD) (MM)	Approx. Net Weight (KG)
WT-HDR-12	12	2.3	75	220/20	640x440x850	110x110x040	22
WT-HDR-25	25	3.5	135	220/20	800x420x995	150x150x073	34
WT-HDR-50 / WT-HDDR-50	50	5	135	380/30	900x600x1160	160x160x073	45
WT-HDR-75 / WT-HDDR-75	75	6	180	380/30	900x600x1255	160x160x073	56
WT-HDR-100 / WT-HDDR-100	100	7	215	380/30	1000x650x1360	177x177x081	68
WT-HDR-150 / WT-HDDR-150	150	10	320	380/30	1300x700x1545	177x177x081	78
WT-HDR-200 / WT-HDDR-200	200	12	320	380/30	1350x800x1710	230x230x083	110
WT-HDR-300 / WT-HDDR-300	300	15	320	380/30	1300x900x1935	230x230x114	150
WT-HDR-400 / WT-HDDR-400	400	18	410	380/30	1400x950x1935	280x280x120	170
WT-HDR-600	600	24	1030	380/30	1550x1150x2350	280x280x135	280
WT-HDR-800	800	27	2200	380/30	1770x1180x2630	280x280x135	380

PS.: 1) "HDDR" stands for high temperature insulation type of dryer. 2) Above loading capacity is based on plastic raw material particles with bulk density about 0.65KG/L and diameter of 3-5mm.

We reserve the right to change specifications without prior notice.

HOPPER DRYER (ECO TYPE)

FEATURE:

- With double-effect energy-saving and long-life heating rods, 20%-40% energy saving compared with standard dryers. With self-protection function and will not damage the machine due to blower damage, contactor failure and other reasons.
- LCD microcomputer controller with temperature control accuracy of $\pm 0.1^{\circ}\text{C}$.
- The barrel body is made of stainless steel to ensure raw materials not to be polluted.
- 24-hour automatic timing device to realize automatic operation of the whole machine by appointment.
- Optional for RS485 communication to realize remote automatic control.

ENERGY SAVING
20%-40%



Comparison of Annual Power Consumption

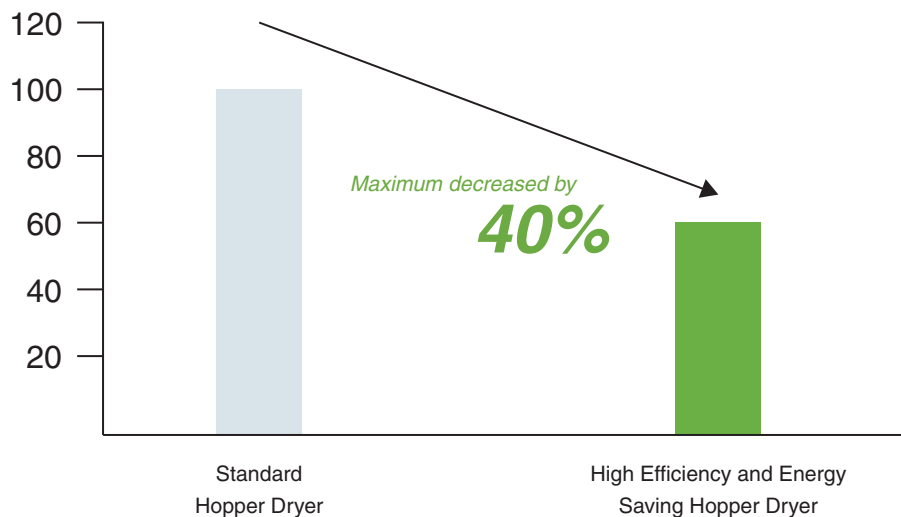

HOPPER DRYER (ACCESSORY)



MATERIAL STORAGE TANK

Customized tank available for all sizes of S/S hopper.

Model	Dimensions (WxDxH) [MM]	Suction box tube dia. [MM]	Thickness of tank material [MM]
25KG	350x350x775	Φ38	1
50KG	500x500x905	Φ38	1
100KG	600x600x910	Φ51	1
200KG	750x750x1170	Φ51	1.5
300KG	850x850x1155	Φ51	1.5
500KG	1050x1050x1242	Φ63	2

Note:
Model in 200KG or below is equipped with wheel.
Customization is available.



DUST COLLECTOR

Additional dust collector installed to avoid plastic particles splashing and provide a clean environment.



MAGNETIC SEPARATOR

Inserts at the lower cone bottom, filter out iron mixed with raw materials, optional model available.



SUCTION BOX

For standing type hopper dryer, easy for material suction and discharge.



Single-tube suction box



Double-tube suction box

FLOOR STAND

Customized a variety of special structure frame of hopper dryer.



HOPPER DRYER (EU TYPE)

FEATURE:

- LCD microcomputer controller with temperature control accuracy of $\pm 0.1^{\circ}\text{C}$.
- Hot air down-blowing design ensures even distribution of hot air to maintain a steady temperature in the hopper and increase drying efficiency.
- Over-temperature trip protection device to reduce accidents caused by man-made or machine failure.
- Double-layer thermal insulation design. Inter layer adopts thick thermal insulation materials to ensure even temperature and less heat loss.
- The contact parts of raw materials are made of stainless steel to ensure not to be polluted.
- Digital timing for 24 hours a week to realize automatic operation.
- WT-HDR-80-EU and above models adopts a checking door, which has good tightness and convenient for material cleaning.
- WT-HDR-1200-EU and smaller models are equipped with stainless steel pallets and bases as standard.
- Optional accessories: Euro suction box, Euro support frame, magnetic stand, magnetic base (aluminum or stainless steel), blower inlet filter, hot air recycling, exhaust air filter.
- Optional frame support under WT-HDR-900-EU.



WT-HDR450-EU

SPECIFICATIONS

Model	WT-HDR-80-EU	WT-HDR-120-EU	WT-HDR-160-EU	WT-HDR-230-EU	WT-HDR-300-EU	WT-HDR-450-EU	WT-HDR-600-EU	WT-HDR-750-EU	WT-HDR-900-EU	
Heater Power (KW)	4	4.5	6	9	12	15	18	18	18	
Blower (KW)	0.135	0.21	0.215	0.32	0.32	0.32	0.5	1.5	1.5	
Hopper Capacity (L)	80	120	160	230	300	450	600	750	900	
Dimensions (HxWxD) (MM)	933x730x500	1175x730x505	1195x810x610	1495x865x610	1490x980x730	1840x1005x725	1815x1215x920	1975x1255x920	2085x1345x1010	
Floor Stand (HxWxD) (MM)	864x732x550	865x735x550	865x800x670	865x800x670	1015x950x790	1015x950x790	1145x1200x1000	1145x1200x1000	1040x1270x1220	
Whole Height (MM)	1510	1750	1725	2010	2080	2430	2425	2575	2600	
Air Outlet Pipe Diameter	2"	2.5"	2.5"	3"	3"	3"	4"	4"	4"	
Suction Box Pipe Diameter (MM)	Φ38					Φ51				
Approx. Net Weight (KG)	80	90	110	110	110	130	200	220	250	

Note: 1. "P" is marked at the back of models for polished inner hopper. 2. "HT" is marked at the back of models when high-temp of 180°C is requested.
 3. Blower is included in machine net weight, but floor stand is not included. 4. Power supply: 3 ,380V,50Hz.
 We reserve the right to change specifications without prior notice.

Model	WT-HDR-1200-EU	WT-HDR-1500-EU	WT-HDR-2300-EU	WT-HDR-3000-EU	WT-HDR-4500-EU	WT-HDR-6000-EU	WT-HDR-7500-EU
Heater Power (KW)	30	32	38	48	80	96	120
Blower (KW)	1.5	2.2	3.7	3.7	5.5	7.5	11
Hopper Capacity (L)	1200	1500	2300	3000	4500	6000	7500
Dimensions (HxWxD) (MM)	2540x1450x1050	2890x1450x1050	3030x1650x1250	3630x1660x1300	5180x2670x1630	5700x2900x1850	4955x2325x1875
Whole Height (MM)	3140	3490	3630	4230	5180	5700	5555
Air Outlet Pipe Diameter	4"	5"	6"	6"	8"	8"	8"
Air Inlet Pipe Diameter	4"	5"	6"	6"	8"	8"	8"
Diameter of Suction Box (MM)	Φ51			Φ63			
Blower Stand H3xW3xD3	-	-	-	1300x750x630	1600x800x1000	1980x930x1200	1360x780x850
Approx. Net Weight (KG)	450	500	650	740	940	1210	1200

Note: 1. For polished hopper inside, plus "P" at model behind. 2. Mark "HT" at the back of models when 180 high-temp is requested.
 3. Blower is included in machine net weight, but floor stand is not included. 4. Power supply: 3 ,380V,50Hz.
 We reserve the right to change specifications without prior notice.

HONEYCOMB DEHUMIDIFIER

FEATURE:

- LCD microcomputer controller with temperature control accuracy of $\pm 0.1^{\circ}\text{C}$.
- Double coolers in large models are adopted to ensure the return air temperature be with low temperature and dew point.
- Applicable to multiple drying barrels for dehumidifying and drying raw materials.
- Internal return air filter to avoid dust from materials contaminating the honeycomb.
- Optional for dew point monitor for easy observation.



Advanced Gear Motor



Honeycomb



WT-DHM1-80

HUMIDITY AND MOISTURE CONTENT

Dew-Point ($^{\circ}\text{C}$)	Relative Humidity (%)	Moisture Content	
		PPM	%
20	100.00	23,072	2.307
+10	52.50	12,117	1.212
0	26.10	6,027	0.603
-10	11.20	2,574	0.257
-20	4.40	1,025	0.103
-30	1.60	378	0.038
-40	0.60	128	0.013
-50	0.20	39	0.004

SPECIFICATIONS

Model	Process Air Flow (M^3/HR)	Process Blower (KW)	Regen. Heater (KW)	Regen. Blower (KW)	Pipe Dia. (INCH)	Voltage (V)	Dimensions (HxWxD) (MM)	Weight (KG)	Diameter of Cooling Water Pipe
WT-DHM1-30	30	0.25	0.25	3	2"	3 ϕ 400V 50Hz	1670x560x710	120	3/4"
WT-DHM1-50	50	0.37	0.25	3	2"		1670x560x710	120	3/4"
WT-DHM1-80	80	0.75	0.25	3.5	2.5"		1670x560x710	120	3/4"
WT-DHM1-120	120	0.75	0.25	3.5	2.5"		1730x650x900	140	3/4"
WT-DHM1-150	150	1.5	0.37	4	3"		1730x650x900	215	3/4"
WT-DHM1-200	200	1.5	0.37	5.4	3"		1970x700x1200	225	3/4"
WT-DHM1-300	300	2.2	0.75	7.2	3"		1970x700x1200	240	3/4"
WT-DHM1-400	400	3.75	0.75	7.2	4"		1970x750x1200	280	3/4"
WT-DHM1-500	500	5.5	1.5	10	4"		1950x940x1630	290	3/4"
WT-DHM1-700	700	5.5	1.5	10	4"		1950x940x1630	300	3/4"
WT-DHM1-1000	1000	7.5	3	15	5"		2210x2260x1930	400	2"
WT-DHM1-1500	1500	5.5x2	2.2x2	10x2	6"		2210x2260x1930	510	2"
WT-DHM1-2000	2000	7.5x2	3x2	15x2	6"		2270x2250x1950	630	2"
WT-DHM1-3000	3000	11x2	4x2	24x2	8"		2270x2250x1950	760	2"

Note: Process heater is optional to be used with a drying hopper.

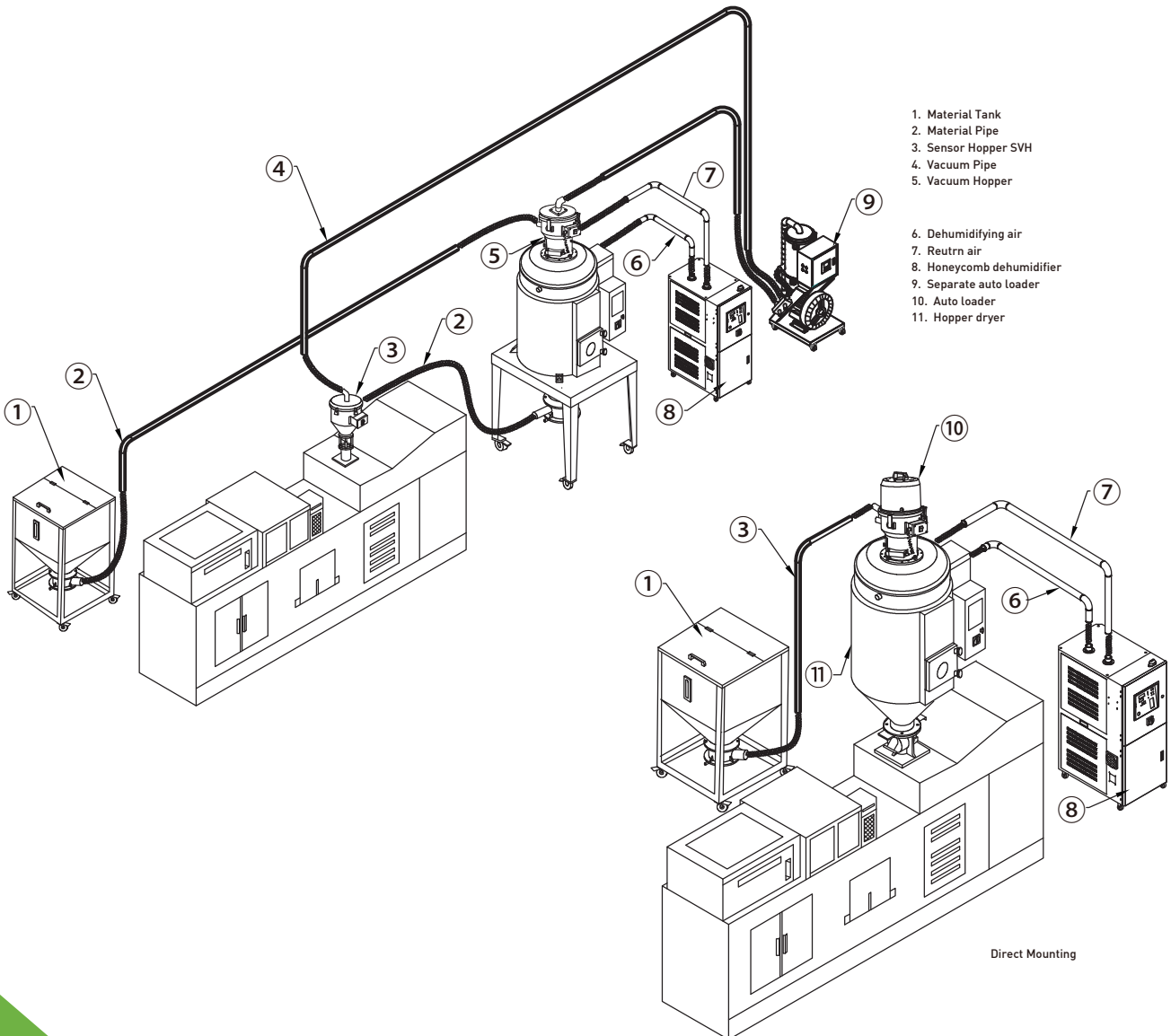
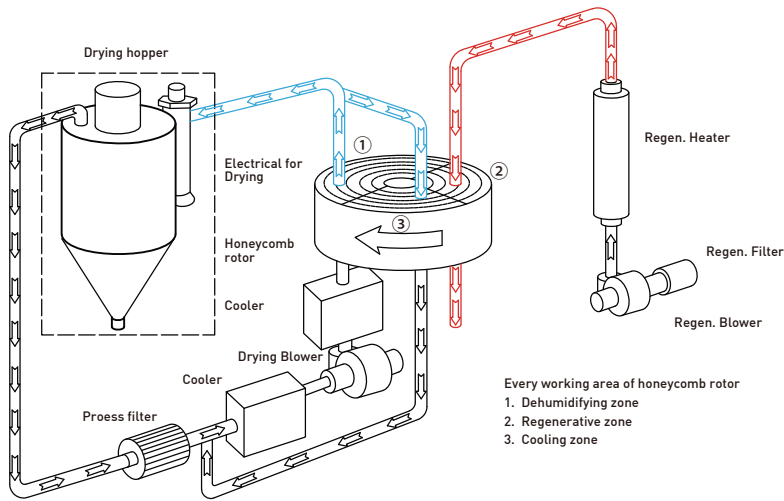

Note:
Direct mounting type Euro Dryers are only available for WT-DHM1-230 and smaller models.

2 IN 1 DRY-DEHUMIDIFIER

FEATURE:

- Equipped with a honeycomb dehumidifier, with semi-integral structure as clean and tidy exterior, combined dehumidifying and drying functions together. One dehumidifier is workable to multi hoppers.
- Insulated drying hopper adopts downward-blowing with cyclone exhaust device to improve drying efficiency, prevent heat loss and ensure dryness.
- Double cooler structure to ensure lower return air temperature and low dew point for the large models.
- Digital timing for 24 hours a week to realize automatic operation.
- LCD microcomputer controller with temperature control accuracy of $\pm 0.1^{\circ}\text{C}$.
- Optional for dew point monitor for easy observation.
- Optional for single-stage or double-stage auto loader for convenient conveying raw materials and dried outputs.



WT-DHM2-1000D

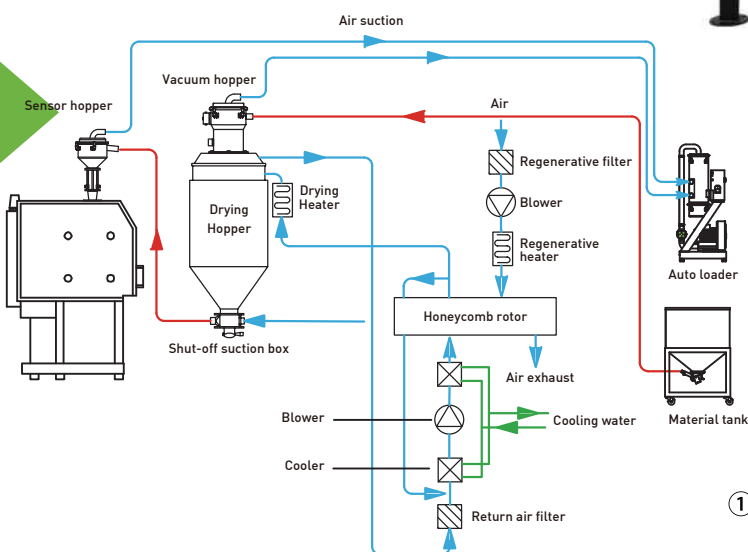

1. Euro-auto loader
2. Standard separate-vacuum hopper loader
3. Air suction pipe
4. Vacuum hopper
5. Return air
6. Material tank
7. Material suction pipe
8. Compact dehumidifying dryer

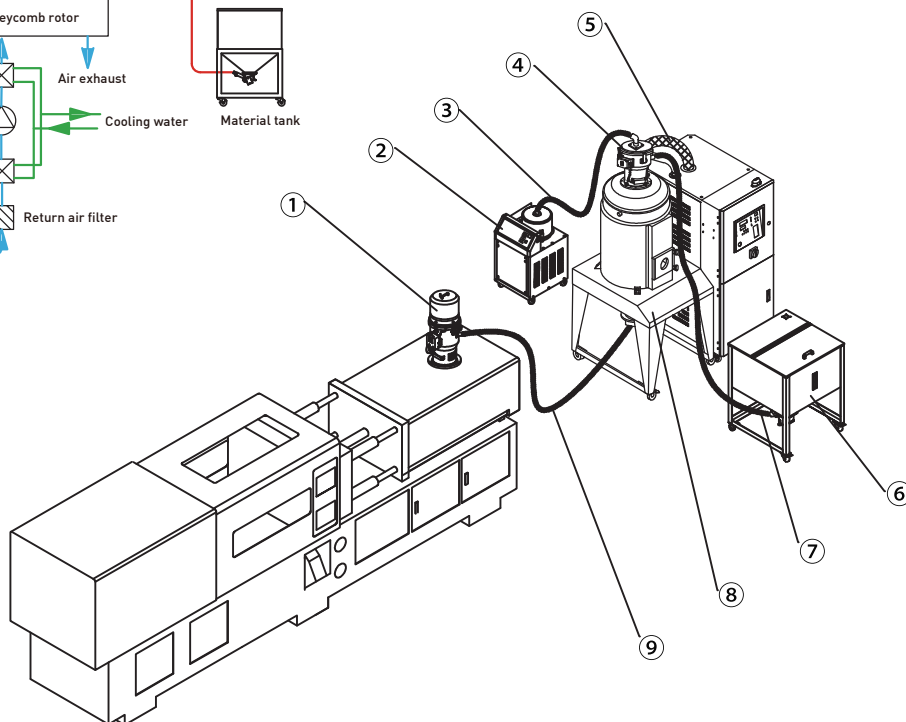

COMPARISON TABLE OF RAW MATERIAL DRYING TIME

Raw Material	Drying Temp. (°C)	Drying Time (HR)	Specfic Heat (J/KG. °C)	Material Special Gravity	Moisture Content Before Drying	Moisture Content After Drying	Drying Capacity Model: WT-DHM2- [XX]												
							30D	50D	80D	120D	150D	200D	300D	400D	500D	700D	1000D	1500D	2000D
ABS	80	2-3	0.34	0.6	0.3	0.02	11	18	27	35	71	105	180	210	285	355	425	710	1065
CA	75	2-3	0.5	0.5	1	0.02	9	15	22	30	60	90	150	180	235	295	355	590	855
CBA	75	2-3	0.5	0.5	0.8	0.2	9	15	22	30	60	90	150	180	235	295	355	590	885
CP	75	2-3	0.6	0.6	1	0.02	11	18	27	35	71	106	180	210	235	355	425	710	1060
LCP	150	4	0.6	0.6	0.04	0.02	8	13	20	27	55	80	135	160	210	265	320	530	800
POM	100	2	0.35	0.6	0.2	0.02	16	27	40	53	105	160	265	320	425	530	640	1060	1600
PMMA	80	3	0.35	0.65	0.5	0.02	11	19	29	38	77	115	192	230	307	383	460	767	1150
IONOMER	90	3-4	0.55	0.5	0.1	0.04	7	11	17	22	44	66	111	133	177	220	265	442	663
PA6/6.6/6.10	75	4-6	0.4	0.65	1	0.05	6	10	14	19	38	58	96	115	153	192	230	383	575
PA11	75	4-5	0.58	0.65	1	0.05	7	12	17	23	46	69	115	138	184	230	275	460	690
PA12	75	4-5	0.28	0.65	1	0.05	7	12	17	23	46	69	115	138	184	230	275	460	690
PC	120	2-3	0.28	0.7	0.3	0.01	13	21	31	41	83	124	206	250	330	413	495	826	1238
PU	90	2-3	0.45	0.65	0.3	0.02	11	19	29	38	77	115	190	230	307	383	460	767	1150
PBT	130	3-4	0.3-0.5	0.7	0.2	0.02	9	15	23	31	62	93	155	186	248	310	372	620	930
PE	90	1	0.55	0.6	0.01	<0.01	32	53	80	106	212	318	531	637	850	1062	1275	2125	3185
PEI	150	3-4	0.3-0.5	0.6	0.25	0.02	8	13	20	27	53	80	133	160	212	265	320	530	800
PET	160	4-6	0.55	0.85	0.2	0.05	8	13	19	25	50	75	125	150	200	250	300	500	750
PETG	70	3-4	0.6	0.6	0.5	0.02	8	13	20	27	53	80	133	160	212	265	320	530	800
PEN	170	5	0.85	0.85	0.1	0.05	9	15	23	30	60	90	150	180	240	300	360	600	900
PES	150	4	0.7	0.7	0.8	0.02	9	15	23	30	60	90	150	180	240	300	360	600	900
PMMA	80	3	0.65	0.65	0.5	0.02	11	19	29	38	77	115	190	230	310	385	460	765	1150
PPO	110	1-2	0.4	0.5	0.1	0.04	13	22	33	44	88	133	220	265	355	440	530	885	1330
PPS	150	3-4	0.6	0.6	0.1	0.02	8	13	20	27	53	80	133	160	212	265	320	530	800
PI	120	2	0.27	0.6	0.4	0.02	16	27	40	53	105	160	265	320	425	530	640	1060	1600
PP	90	1	0.46	0.5	0.1	0.02	26	44	66	88	180	265	442	530	710	885	1060	1770	2655
PS (GP)	80	1	0.28	0.5	0.1	0.02	26	44	66	88	180	265	442	531	708	885	1062	1770	2655
PSU	120	3-4	0.31	0.65	0.3	0.02	8	14	22	29	60	85	145	173	230	290	345	575	865
PVC	70	1-2	0.2	0.5	0.1	0.02	13	22	33	44	90	135	220	265	355	442	530	885	1330
PAN (AS)	80	1-2	0.32	0.5	0.1	0.05	13	22	33	44	90	135	220	265	355	442	530	885	1330
TPE	110	3	0.7	0.7	0.1	0.02	13	20	30	40	85	125	205	250	330	413	495	826	1238

Note:
 1. Use separated drying hopper.
 2. Moisture content lower than 0.005% after drying when in 20°C environment and 65% relative humidity.

We reserve the right to change specifications without prior notice.

3 IN 1 DRY-LOAD-DEHUMIDIFIER

FEATURE:

- Equipped with honeycomb rotor to obtain stable low dew point dry air. Structure models are divided into semi-integral and full-integral.
- With functions of dehumidification, drying, and two-stage feeding, and with available option for three-stage feeding. Heat-insulated hopper dryer adopts downward blowing design and cyclone exhaust device to prevent heat loss and ensure humidity.
- All models are equipped with a closed loop feeding system to prevent the dried materials from being damp again due to contact with outside air.
- Large models are adopted double cooler structure to ensure lower return air temperature and low dew point.
- Equipped with pneumatic shut-off valve to ensure no material remains in the material line after each loading cycle.
- LCD microcomputer controller with temperature control accuracy of $\pm 0.1^{\circ}\text{C}$.
- Digital timing for 24 hours a week to realize automatic operation.
- Optional for dew point monitor for easy observation.



WT-DHM3-120L/80D

SPECIFICATIONS (FULL-INTEGRAL DESIGN)

Model	WT-DHM3-40L/30D	WT-DHM3-80L/50D	WT-DHM3-120L/80D	WT-DHM3-160L/120D	WT-DHM3-230L/150D
Drying System					
Process Heater Power (KW)	3	4	6	6	7.2
Process Blower Power (KW)	0.25	0.37	0.75	0.75	1.5
Drying Hopper Capacity (L)	40	80	120	160	230
Dehumidifying System					
Regen Heater Power (KW)	3	3	3.5	3.5	4
Regen Blower Power (KW)	0.25	0.25	0.25	0.25	0.37
Dry Air Capacity (M ³ /HR)	30	50	80	120	150
Conveying System					
Conveying Blower Power (KW)	0.75	1.1	1.1	1.1	1.5
Dia. of Conveying Hose (INCH)	1.5	1.5	1.5	1.5	1.5
Vacuum Hopper (L)	7.5	7.5	7.5	7.5	7.5
Sensor Hopper (L)	7.5	7.5	7.5	7.5	7.5
Dimensions (HxWxD) (MM)	1700x1100x710	1820x1100x710	1820x1100x710	1910x1320x900	1940x1320x900
Weight (KG)	200	300	320	505	540

We reserve the right to modify the above information without prior notice.

- 1. Sensor hopper
- 2. Vacuum pipe
- 3. Material pipe
- 4. Vacuum hopper
- 5. Material tank
- 6. XCD Main unit

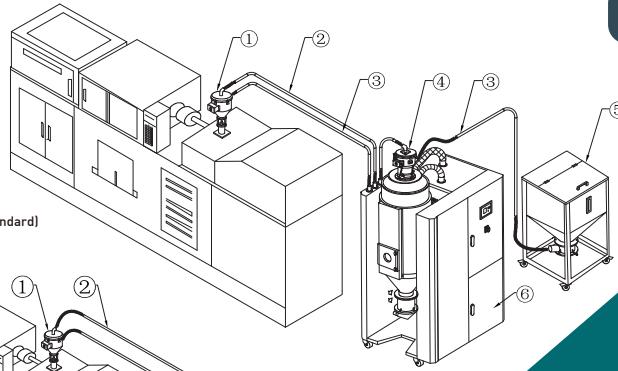

For Servicing One Machine: Two-stage Conveying System (Standard)

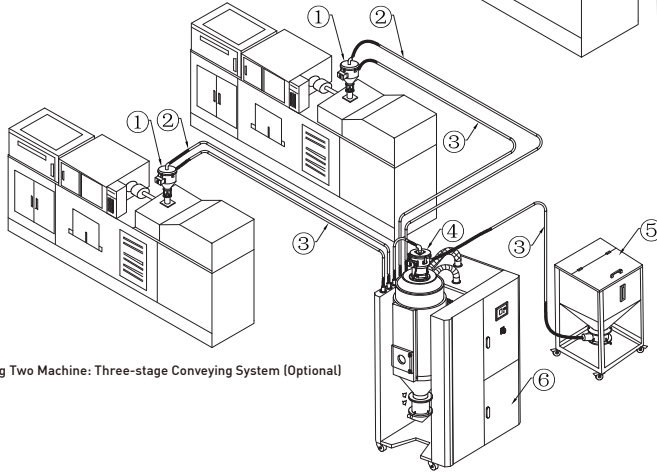

For Servicing Two Machine: Three-stage Conveying System (Optional)

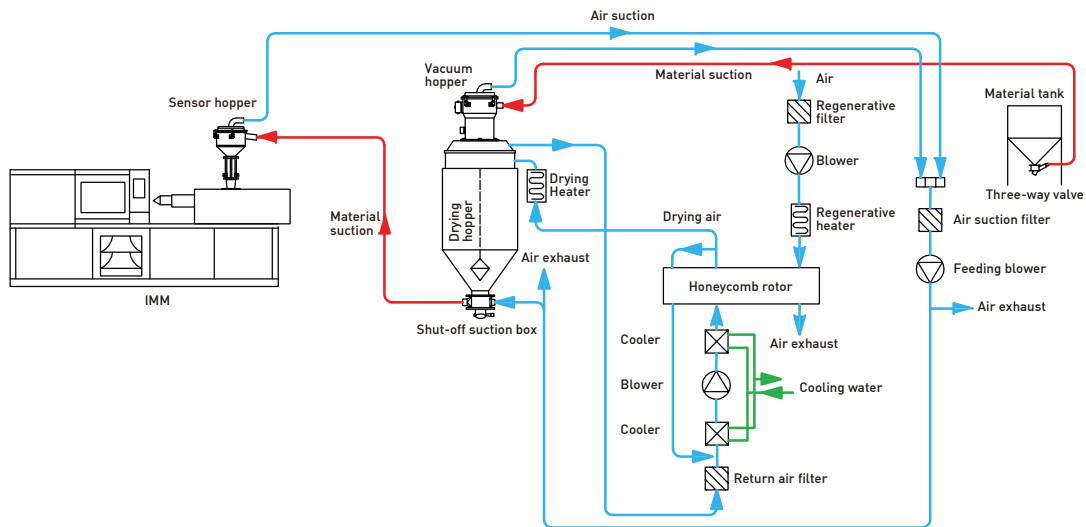

SPECIFICATIONS (SEMI-INTEGRAL DESIGN)

Model	WT-DHM3S-300L/200D	WT-DHM3S-450L/300D	WT-DHM3S-600L/400D	WT-DHM3S-750L/500D	WT-DHM3S-900L/700D	WT-DHM3S-1200L/700D	WT-DHM3S-1500L/1000D
Drying System							
Process Heater Power (KW)	12	15	18	18	24	30	32
Process Blower Power (KW)	1.5	2.2	2.2	3.7	3.7	5.5	5.5
Drying Hopper Capacity (L)	300	450	600	750	900	1200	1500
Dehumidifying System							
Regen Heater Power (KW)	5.4	7.2	7.2	10	10	10	15
Regen Blower Power (KW)	0.37	0.75	0.75	1.5	1.5	3	3
Dry Air Capacity (M ³ /HR)	200	300	400	500	700	700	1000
Conveying System							
Conveying Blower Power (KW)	1.5	1.5	1.5	2.2	3.75	5.5	5.5
Dia. of Conveying Hose (INCH)	2	2	2	2	2	2	2
Vacuum Hopper (L)	12	12	12	12	24	24	24
Sensor Hopper (L)	12	12	12	12	24	24	24
Dimensions (HxWxD) (MM)	2100x1800x1200	2500x1800x1200	2500x2100x1200	2600x2300x1650	2600x2400x1650	3800x2300x1650	4100x3600x1950
Weight (KG)	565	600	640	710	850	900	1160

Note:
 1. *** stand for by-pass at blower air outlet.
 2. Power supply: 3Φ, 400V, 50Hz.
 3. DHM3S-1500L/1000D and above models are equipped with cyclone dust collector as standard to prolong the service life.
 We reserve the right to change specifications without prior notice.

MOLD DEHUMIDIFIERS

FEATURE:

- LCD microcomputer controller monitoring regenerative and present temperature.
- Honeycomb rotor to provide constant full year dehumidified dry air.
- Alarm function on motor overload and phase reverse.
- Return air cooling and filtering are included.
- Extending mould lifetime, inhibiting corrosion and reducing insufficient issues and ratio.
- Default with cooler at dry air outlet and available to adjust temperature.
- Auto function on draining condensation water in time.
- Optional for detachable return air collector to realize closed-loop air circulation, especially for regions with high humidity.
- Optional for dew point monitor for easy observation.



WT-MDH-2000

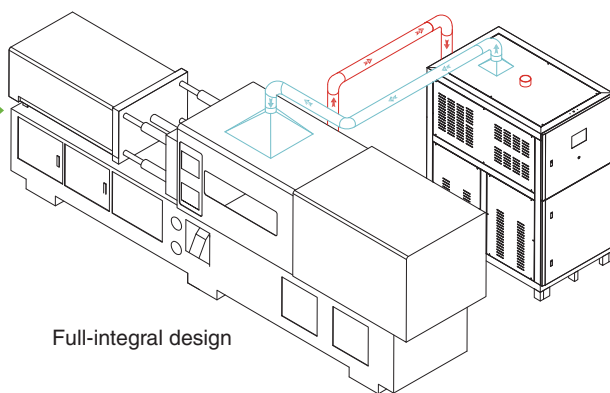

Full-integral design

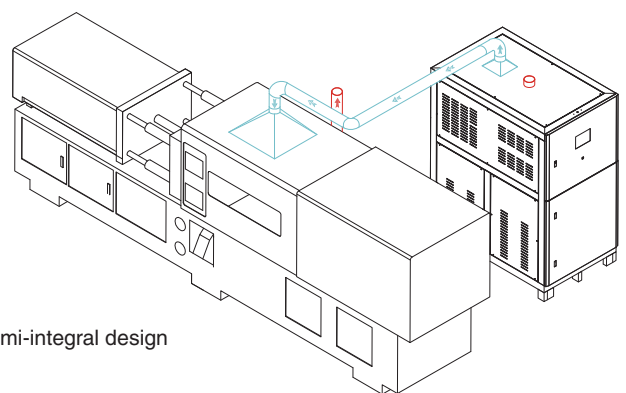

Semi-integral design

SPECIFICATIONS

Model	WT-MDH-1000	WT-MDH-2000	WT-MDH-3000
Regenerative Heater (KW)	12	24	30
Regenerative Blower (KW)	0.32	0.55	0.75
Drying Blower (KW)	1.5	2.2	3.7
Dry Air Flow (M ³ /HR)	1000	2000	3000
Dry Air Tube (INCH)	8	10	10
Regen. Air Tube (INCH)	4	6	6
Cooler Outlet	1.5" PT.5	1.5" PT	2" PT
Dry Air Temp. (°C)	≤16	≤16	≤16
Dew Point (°C)	-10~+5	-10~+5	-10~+5
Cooling Water Flow (L/MIN)	≥100	≥150	≥190
Water Pressure (KGF/CM ²)	1-5	1-5	15
Dimension (HxWxD) (MM)	1950x750x1400	2350x1150x1300	2600x1300x1300
Approx. N. G. (KG)	321	580	700

Remark:

1. Noise ≤90dB(A).
2. Open use conditions: ambient drying temperature ≤ 35°C, relative humidity ≤ 70%.
3. Cooling water temperature required: 7°C.
4. Machine power standard: 3Ø, 380VAC, 50Hz.

We reserve the right to change specifications without prior notice.

MOLD TEMPERATURE CONTROLLER (WATER / OIL TYPE)

FEATURE:

- Temperature control range: water heating temperature can reach 120°C, oil heating temperature can reach 200°C.
- Advanced LCD microcomputer controller with temperature control accuracy of $\pm 0.1^{\circ}\text{C}$.
- Protective devices: auto-exhaust by start-up and auto-cooling by turn off, thermocouple disconnection alarm, anti-phases, safety relief, water pump protection, overheat and oil shortage.
- SUS304 stainless steel seamless heating barrel and main pipelines can ensure corrosion-resistant, no leakage and long working lifetime.
- Digital timing for 24 hours a week to realize automatic operation.
- Optional for oil return type to recycle heat transfer oil conveniently and quickly.
- Optional for RS485 communication to realize remote automatic control.



WT-MTC-9K-O

SPECIFICATIONS

Model	Transfer Medium	Max. Temp.	Pump (KW)	Pump Flow (L/MIN)	Loading Distance (M)	Volume of oil tank	Heating Power (KW)	Inlet / Outlet Diameter	Dimensions (MM)	Approx. Net Weight (KG)
WT-MTC-6K-W	Water	100°C	0.37	42	28	/	6	3/8"x2	730x310x643	45.5
WT-MTC-9K-W100			0.75	56	38	/	9	3/8"x4	730x310x643	49
WT-MTC-12K-W100			0.75	56	38	/	12	3/8"x4	730x310x643	50
WT-MTC-18K-W100			1.5	110	60	/	9x2	1"x1	830x370x694	73
WT-MTC-24K-W			1.5	110	60	/	12x2	1"x1	830x370x694	76
WT-MTC-36K-W			2.2	140	85	/	12x3	1.5"x1	1090x520x983	132
WT-MTC-6K-O	Heat-Transfer Oil	200°C	0.37	42	28	6L	6	3/8"x2	730x310x643	49
WT-MTC-9K-O			0.75	56	38	6L	9	3/8"x4	730x310x643	52.5
WT-MTC-12K-O			0.75	56	38	6L	12	3/8"x4	730x310x643	55
WT-MTC-18K-O			1.5	110	60	13L	9x2	1"x1	830x370x694	80
WT-MTC-24K-O			1.5	110	60	13L	12x2	1"x1	830x370x694	135
WT-MTC-36K-O			2.2	140	815	30L	12x3	1.5"x1	1090x520x983	193

We reserve the right to modify the above information without prior notice.

MOLD TEMPERATURE CONTROLLER (HIGH TEMP. WATER TYPE 160-180C)

FEATURE:

- Temperature control range within 180° (Optional for magnetic pump).
- LCD microcomputer controller with temperature control accuracy of ±0.1°C.
- Efficient water pump to keep accurate temperature level and achieve precise molding.
- Multiple safety devices including high-pressure protection, overheat protection, inlet water pressure deficit protection, safety pressure relieving, automatic water supplying, boot automatically exhaust and shut down automatically cooling protection.
- Water level detection and electronic booster pump to ensure accurately monitor the water level automatically replenish water to avoid dry burning of the electric heater.
- SUS304 stainless steel seamless heating barrel, water storage barrel and main pipelines to ensure corrosion-resistant, no leakage and long working lifetime.
- Indirect cooling method to make temperature controller more precise and realize fast heat exchange.
- Digital timing for 24 hours a week to realize automatic operation.
- Isolated electric control box for long service life.



WT-MTC-9K-W160

SPECIFICATIONS

Model	Unit	WT-MTC-9K-W160	WT-MTC-12K-W160	WT-MTC-18K-W160	WT-MTC-9K-W180	WT-MTC-12K-W180	WT-MTC-18K-W180
Temp. Control Range	°C	160°C			180°C		
Temp. Control Accuracy	°C	P.I.D±0.1°C			P.I.D±0.1°C		
Power Supply		AC3Φ380V/50Hz			AC3Φ380V/50Hz		
Heat Transfer Medium		Water					
Cooling Method		Indirect Cooling					
Heating Power	KW	9	12	9x2	9	12	9x2
Pump Power	KW	0.75	0.75	1.5	0.5	1.1	1.1
Max. Pump Flow	L/MIN	135	135	235	30	50	50
Max. Pump Pressure	KG/CM²	2.5	2.5	2.5	3.5	3.5	3.5
Alert Function		Phase-Missing/Water Insufficient/Over-Heat/Over Current					
Cooling Water Pipe	MM	12	12	12	12	12	12
Circulating Water Pipe	INCH	{4x4} 3/8	{4x4} 3/8	{1x1} 1"	{4x4} 3/8	{4x4} 3/8	{1x1} 1"
Dimensions (LxWxH)	MM	790x400x760	790x400x760	1090x515x990	790x400x760	790x400x760	1090x515x990
Approx. Net Weight	KG	83	86	130	85	88	135

We reserve the right to modify the above information without prior notice.

MOLD TEMPERATURE CONTROLLER (HIGH TEMP. OIL TYPE 300C)

FEATURE:

- Heating temperature ranges from 45-300°C.
- LCD microcomputer controller with temperature control accuracy of ±0.1°C.
- High temperature coupling pumps to ensure no oil leakage.
- Over-temperature protection, low water inlet pressure protection, multiple safety relief devices, automatic water replenishment and start-up exhaust function, shutdown automatic cooling.
- SUS304 stainless steel seamless heating barrel, water storage barrel and main pipelines to ensure corrosion-resistant, no leakage and long working lifetime.
- Indirect cooling method to make temperature controller more precise and realize fast heat exchange.
- Isolated electric control box for long service life.
- Digital timing for 24 hours a week to realize automatic operation.



WT-MTC-24K-0300

SPECIFICATIONS

Model	Unit	WT-MTC-12K-0300	WT-MTC-18K-0300	WT-MTC-24K-0300	WT-MTC-36K-0300	WT-MTC-48K-0300	WT-MTC-60K-0300	WT-MTC-18K-0300	WT-MTC-24K-0300	WT-MTC-36K-0300
Temp. Control Range	°C	300°C						320°C		
Temp. Control Accuracy	°C	P.I.D±0.1°C								
Power Supply		AC3Φ380V/50Hz								
Heat Transfer Medium		Heat Transfer Oil								
Cooling Method		Indirect Cooling								
Heating Capacity	KW	12	9x2	12x2	12x3	12x4	12x5	9x2	12x2	12x3
Pump Power	KW	0.75	1.5	1.5	2.2	3	5.5	0.5	1.1	1.1
Max. Pump Flow	L/MIN	50	83	83	165	300	330	25	60	60
Max. Pump Pressure	KG/CM²	2	2.5	2.5	2.5	3	3	4	6	6
Oil Tank Capacity	Liter	50	50	50	50	50	50	50	50	50
Alert Function		Phase Loss/Oil Shortage/Over-Heat/OverLoad								
Cooling Water Pipe	MM	12	12	12	12	12	12	12	12	12
Circulating Oil Pipe	INCH	[1x1]	[1x1]	[1x1]	[1.5x1.5]	[2x2]	[2x2]	[1x1]	[1x1]	[1.5x1.5]
Dimensions (LxWxH)	MM	1325x560x1110	1325x560x1110	1325x560x1110	1325x560x1110	1325x560x1650	1325x560x1650	1325x560x1110	1325x560x1110	1325x560x1110
Approx. Net Weight	KG	205	210	215	220	225	240	205	215	220

Note:
We reserve the right to change specifications without prior notice.

Calculation Formula:
Heating Power (KW) = mold weight (KG) * mold heat specific (kcal/(KG·°C))*molding temperature difference (°C) x safety factor/heating time/860
Notice: Safety factor ranges from 1.3 to 1.5.

Notice:
1. Water specific heat=1kcal/(KG
2. Heating Oil specific heat=0.49Kcal/KG·°C
3. Water density=1KG/L
4. Heating Oil density=0.842KG/L

Flow Rate(L/min)=Heating Power(KW)*860/[medium specific heat(kcal/(KG·°C))*medium density(KG/L)*inlet and outlet temperature difference*time(60)]

MOLD TEMPERATURE CONTROLLER (MULTIPLE)

FEATURE:

- Newly designed with small footprint and multi-function.
- Separate control-available for maintaining two molds or two machines with different or individual settings.
- Easy to operate and maintain, with exquisite exterior.
- Well-constructed interior pipelines with concise and well-knit designation for energy saving.
- SUS304 stainless steel seamless heating barrel, water storage barrel and main pipelines to ensure corrosion-resistant, no leakage and long working lifetime.
- Electrical appliances are effectively separated from the heating device to achieve good heat insulation and avoid the damage caused by high temperature.
- Digital timing for 24 hours a week to realize automatic operation.
- Available to choose 3-in-1 or 4-in-1 design according to different cases.



SPECIFICATIONS

Model	Transfer Medium	Max. Temp.	Pump (KW)	Pump Flow (L/MIN)	Loading Distance (M)	Heating Power (KW)	Inlet / Outlet Diameter	Dimensions (MM)	Approx. Net Weight (KG)
WT-MTC-6K2-W	Water	100°C	0.37x2	42	28	6x2	3/8" x4	900x370x1050	98
WT-MTC-9K2-W			0.75x2	56	38	9x2	3/8" x8	900x370x1050	112
WT-MTC-12K2-W			0.75x2	56	38	12x2	3/8" x8	900x370x1050	125
WT-MTC-18K2-W			1.5x2	160	27	9x4	1" x2	870x450x1300	150
WT-MTC-24K2-W			1.5x2	160	27	12x4	1" x2	870x450x1300	180
WT-MTC-36K2-W			2.2x2	315	30	12x6	1.5" x2	1100x550x1350	190
WT-MTC-6K2-O	Heat-Transfer Oil	200°C	0.37x2	42	28	6x2	3/8" x4	900x370x1050	98
WT-MTC-9K2-O			0.75x2	56	38	9x2	3/8" x8	900x370x1050	112
WT-MTC-12K2-O			0.75x2	56	38	12x2	3/8" x8	900x370x1050	125
WT-MTC-18K2-O			1.5x2	160	27	9x4	1" x2	870x450x1300	150
WT-MTC-24K2-O			1.5x2	160	27	12x4	1" x2	870x450x1300	180
WT-MTC-36K2-O			2.2x2	315	30	12x6	1.5" x2	1100x550x1350	190

We reserve the right to modify the above information without prior notice.

MEDIUM SPEED GRANULATOR

FEATURE:

- Small footprint and machine size.
- Convenient on maintenance and cleaning, safety design for operations.
- Blades sets made by once cutting from steel plate, adopted with patent front-positioning blades design enlarging cutting angle and increasing cutting efficiency. Hence the output granules are even and with less powder or dust.
- Blades are made of high-strength alloy tool steel, with high hardness, good abrasion resistance, and long durability.
- Adopted hexagon socket screw installation way of the blades, free from wearing lose on screws in long term utility.
- Feeding hopper with double-layered on 4 sides and the inner layer is made of stainless steel with insulation material in between to provide good noise handling.
- Configuration is optional on active or passive collecting.



WT-MSG-250

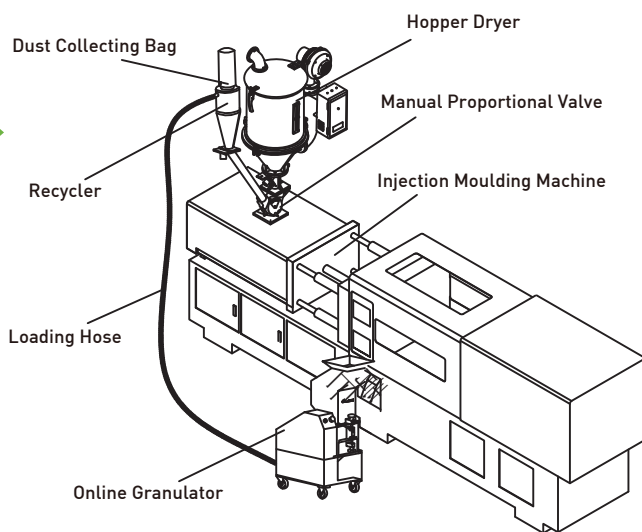

SPECIFICATIONS

Model	WT-MSG-180	WT-MSG-250	WT-MSG-310	WT-MSG-180RC	WT-MSG-250RC	WT-MSG-310RC
Grinding Chamber (MM)	180x180	250x200	310x200	180x180	250x200	310x200
Grinding Capacity (KG/H)	40-70	80-100	80-130	40-70	80-100	80-130
Power KW	1.5	2.2	4	1.5	2.2	4
Stationary Cutter (Piece)	2	2	2	2	2	2
Hook Cutter (Piece)	9	12	15	9	12	15
Mesh Size (MM)	6	6	6	6	6	6
Dimensions (LxWxH) (MM)	790x454x1410	790x496x1410	790x556x1410	790x454x1410	790x496x1410	790x556x1410
Spindle Speed (R/MIN)	320	320	320	320	320	320
Blower Power KW (Active Collecting)	/	/	/	0.55	0.55	0.55
Note	Should be used with auto loader and proportional Valve			Equipped with recycled system		

We reserve the right to modify the above information without prior notice.

LOW SPEED GRANULATOR

FEATURE:

- Low speed grinding with V shape stepped rotary cutters design to ensure low noise, evenly output and less dust.
- Capable of auto reserve running and clearing of jammed materials, all-round protection of the motor.
- Direct driven reducer ensures stable running.
- With timing function to turn on or off, saving energy.
- Controlled by microcomputer, easy operation and maintenance.
- Double layered soundproof designed feeding hopper with low noise.
- Fast disassembly and assembly design for processing chamber, easy to clean and maintain.
- With multiple protections as phase sequence protection, overload protection, limit protection.
- Configuration is optional on active or passive collecting. Passive collecting default with dual material proportional valve and controller.



WT-LSG-5

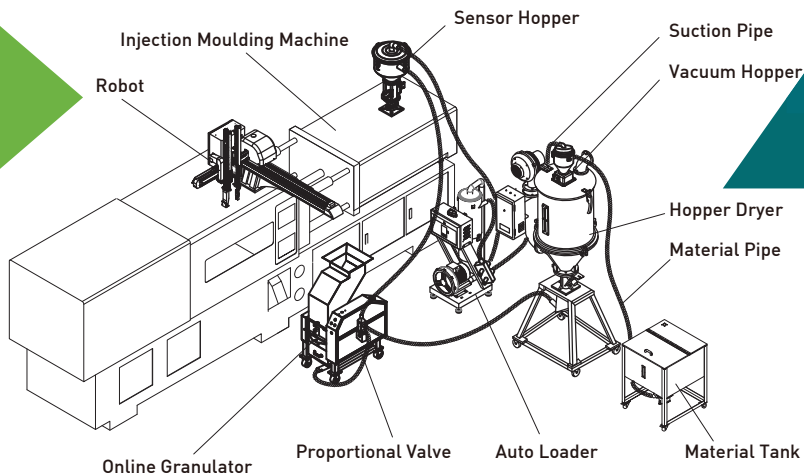

SPECIFICATIONS

Model	WT-LSG-2	WT-LSG-3	WT-LSG-5	WT-LSG-2RC	WT-LSG-3RC	WT-LSG-5RC
Feeding Hopper Size (MM)	320x310	380x310	440x310	320x310	380x310	440x310
Grinding Chamber (MM)	260x310	320x310	380x310	260x310	320x310	380x310
Crinding Capacity (KG/H)	22	27	33	22	27	33
Power KW	1.5	2.2	3.7	1.5	2.2	3.7
Stationary Cutter (Piece)	2	2	2	2	2	2
Hook Cutter (Piece)	27	33	39	27	33	39
Mesh Size (MM)	8	8	8	8	8	8
Dimensions (LxWxH) (MM)	850x500x1500	1000x500x1500	1150x500x1500	850x500x1500	1000x500x1500	1150x500x1500
Spindle Speed (R/MIN)	140	140	140	140	140	140
Blower Power Kw (Active Collecting)	/	/	/	0.55	0.55	0.55
Note	Should be used with auto loader and proportional Valve			Equipped with recycled system		

We reserve the right to modify the above information without prior notice.

SCREENLESS LOW SPEED GRANULATOR

FEATURE:

- With the teeth cutters and hook cutters design, running with low rotary speed, screenless, no leftover, evenly output and least dust produced.
- Capable of auto reverse running and clearing of jammed materials to ensure all-rounded protection for the motor.
- With timing function to turn on or off to save energy.
- Controlled by microcomputer, easy operation and maintenance.
- Double layered soundproof designed feeding hopper with low noise.
- Fast disassembly and assembly design for processing chamber, easy to clean and maintain.
- With multiple protections as phase sequence protection, overload protection, limit protection.
- Configuration is optional on active or passive collecting. Passive collecting default with dual material proportional valve and controller.



WT-SSG-2

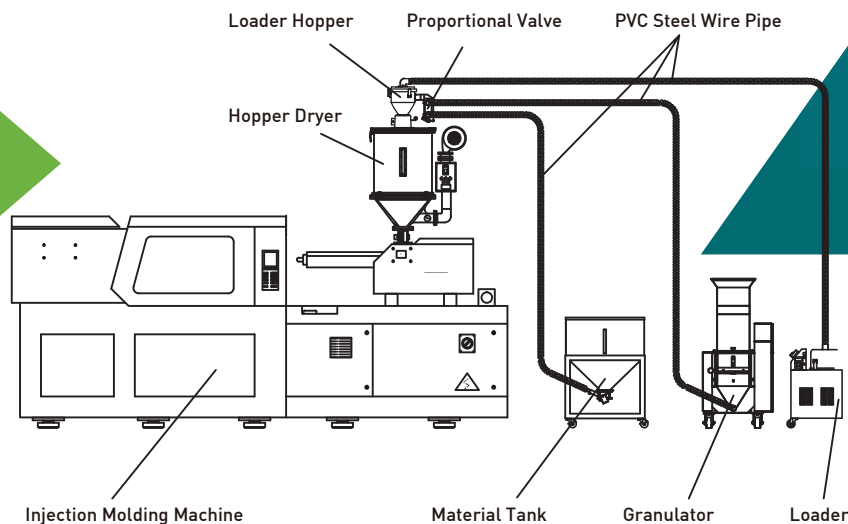

SPECIFICATIONS

Model	WT-SSG-1	WT-SSG-2	WT-SSG-3	WT-SSG-1RC	WT-SSG-2RC	WT-SSG-3RC
Feeding Hopper Size (MM)	505x360	505x470	505x580	505x360	505x470	505x580
Grinding Chamber (MM)	310x200	310x310	310x420	310x200	310x310	310x420
Grinding Capacity (KG)	10-15	20-25	22-27	10-15	20-25	22-27
Power (KW)	1.1	1.5	2.2	1.1	1.5	2.2
Stationary Cutter (Piece)	4	6	8	4	6	8
Teeth Cutter (Piece)	2	3	4	2	3	4
Hook Cutter (Piece)	1	2	3	1	2	3
Dimensions (LxWxH) (MM)	945x570x1315	1055x570x1315	1200x570x1315	945x570x1315	1055x570x1315	1200x570x1315
Spindle Speed (R/MIN)	25	25	25	25	25	25
Blower Power Kw (Active Collecting)	/	/	/	0.37KW	0.37KW	0.37KW
Note	Should be used with auto loader and proportional Valve			Equipped with recycled system		

SOUNDPROOF CRUSHER WITH COLLECTOR

FEATURE:

- Optimized full-hermetic structure with soundproof insulation to keep low noise.
- Multiple safety devices including current relay, motor overload and phase protectors.
- With auto collecting blower for easy and efficient operations.
- With cyclone to separate material and air for easy collecting.
- With dust collecting bag for handy cleaning.
- ≥ 15 HP are applied with booster for feeding hopper.
- ≥ 30 HP default with cylinder on hopper and mesh screen.
- Default with level pad to reduce the vibration when machine running.
- Optional for Dust Sifting Device.



WT-CCG

CLAW / FLAT TYPE CRUSHER

FEATURE:

- Blade sets made by once cutting from steel plate, adopted with patented front-positioning blades design to enlarge cutting angle and ensure even output granules and less powder or dust. Models are divided into claw and flat types with wide applications. And the claw type blades are especially suitable for larger and harder subjects like injection lump plastics.
- Blades are made of high-strength alloy tool steel with high hardness, good abrasion resistance and long durability.
- Hexagon socket screw to be free from wearing lose on screws in long term utility.
- Feeding hopper with double-layered on 4 sides and the inner layer is made of stainless steel with insulation material in between to provide good noise handling.
- ≥ 30 HP default with chamber cooling system, effectively reducing the heat of chamber and shaft to ensure long durability and preventing material melting and fusion.
- ≥ 75 HP with advanced self-aligning bearings to ensure excellent lifetime running.
- ≥ 75 HP with cylinder system on feeding hopper and mesh screen, optional for other models as well.
- Patented design foot stands with heavy duty capability and low vibration in running.
- Optional for auto collecting and dust separating system for better collecting.
- Available of tailor-made special models with better durability and life span on processing materials of PA66/PA6+20%-50% GF.



GY claw cutter saddle



GD flat cutter saddle



WT-CSR-30F

SPECIFICATIONS

Model		WT-CSR-10C	WT-CSR-15C	WT-CSR-20C	WT-CSR-30C	WT-CSR-50C	WT-CSR-75C	WT-CSR-100C
		WT-CSR-10C-SP	WT-CSR-15C-SP	WT-CSR-20C-SP	WT-CSR-30C-SP	WT-CSR-50C-SP	WT-CSR-75C-SP	WT-CSR-100C-SP
Grinding Chamber (MM)		360x260	420x280	480x330	660x350	720x500	910x820	1050x820
Grinding Capacity (KG/H)		170-340	255-420	300-460	420-680	680-1000	700-1200	850-1400
Stationary Cutter (Piece)		2	2	2	4	4	4	4
Rotary Cutter (Piece)		6	6	6	9	9	12	12
Mesh Size (MM)		Φ10	Φ10	Φ10	Φ12	Φ12	Φ12	Φ12
Power	KW	7.5	11	15	22	37	55	75
	HP	10	15	20	30	50	75	100
Dimensions (LxWxHxH1) (MM)		1000x830x1270x960	1200x995x1540x1215	1300x1075x1725x1350	1500x1330x1880x1480	2000x1520x2470x1914	2420x1945x3220x2375	2420x2065x3220x2375
Approx. Net Weight (KG)		540	800	1023	1723	2750	5400	6250
Dimension for sp (MM)		1350x880x1550x1190	1540x1020x1800x1440	1600x1140x1960x1540	1850x1400x2170x1735	2250x1570x2880x2200	2590x2110x3610x2375	2590x2230x3610x2700
Collective Blower (KW)		2.2	2.2	2.2	3	4	5.5	7.5
Approx.N.W.for sp (KG)		750	1180	1400	2280	3630	5900	6500

PS.: "SP" stands for soundproof granulator with collecting device.

We reserve the right to modify the above information without prior notice.

Model		WT-CSR-10F	WT-CSR-15F	WT-CSR-20F	WT-CSR-30F	WT-CSR-50F	WT-CSR-75F	WT-CSR-100F
		WT-CSR-10F-SP	WT-CSR-15F-SP	WT-CSR-20F-SP	WT-CSR-30F-SP	WT-CSR-50F-SP	WT-CSR-75F-SP	WT-CSR-100F-SP
Grinding Chamber (MM)		360x260	420x280	480x330	660x350	720x500	910x820	1050x820
Grinding Capacity (KG/H)		200-400	300-500	350-550	500-800	800-1200	850-1300	1000-1500
Stationary Cutter (Piece)		2	2	2	4	4	4	4
Rotary Cutter (Piece)		18	21	24	27	27	30	33
Mesh Size (MM)		Φ10	Φ10	Φ10	Φ12	Φ12	Φ12	Φ12
Power	KW	7.5	11	15	22	37	55	75
	HP	10	15	20	30	50	75	100
Dimensions (LxWxHxH1) (MM)		1000x830x1270x960	1200x995x1540x1215	1300x1075x1725x1350	1500x1330x1880x1480	2000x1520x2470x1914	2420x1945x3220x2375	2420x2065x3220x2375
Approx. Net Weight (KG)		540	835	1100	1810	2750	5400	6250
Dimension for sp (MM)		1250x880x1475x1190	1420x1020x1760x1440	1500x1140x1920x1540	1750x1400x2140x1735	2150x1570x2770x2200	2590x2110x3610x2700	2590x2230x3610x2700
Collective Blower (KW)		2.2	2.2	2.2	3	4	5.5	7.5
Approx.N.W.for sp (KG)		860	1180	1400	2280	3630	5900	6500

PS.: "SP" stands for soundproof granulator with collecting device.

We reserve the right to modify the above information without prior notice.

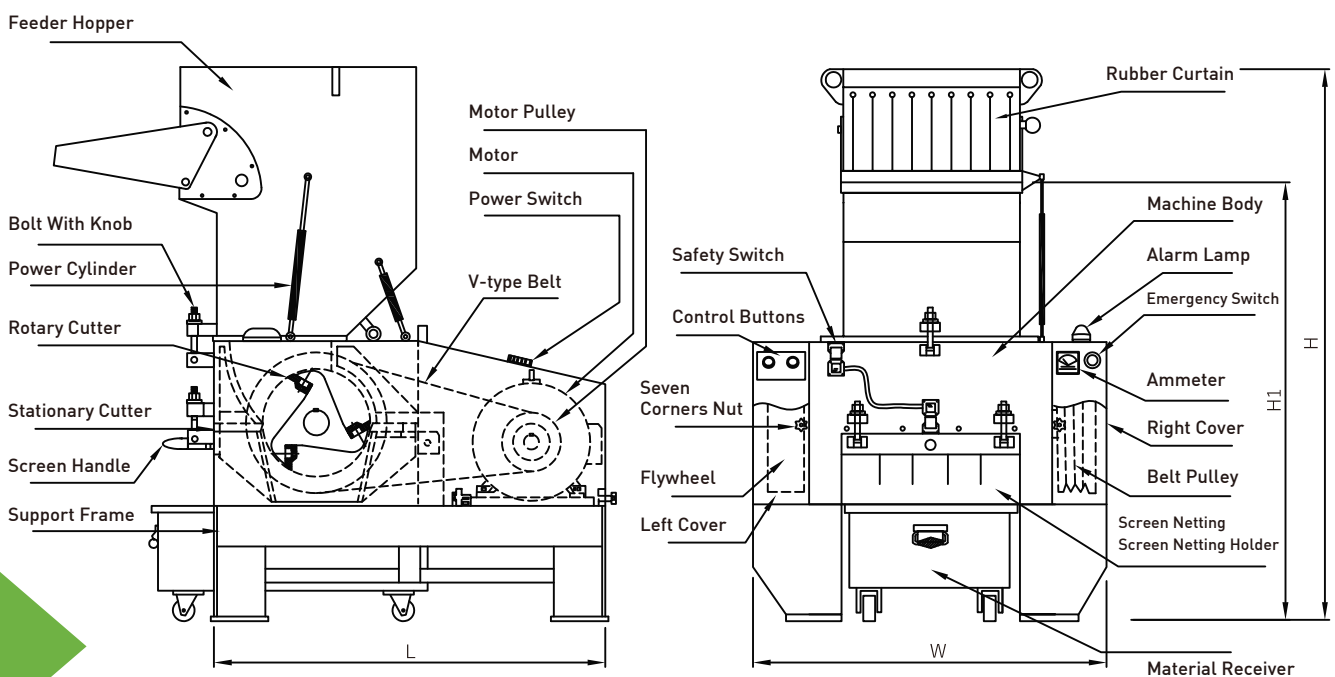

V TYPE CRUSHER

FEATURE:

- Unique scissors type structure to improve cutting efficiency.
- Feeding hopper with back and front double layered insulation for effective noise handling.
- Blades are made of high-strength alloy tool steel with high hardness, good abrasion resistance and long durability.
- Equipped with multiple safety protection devices to ensure safe operation.
- ≥30HP default with chamber cooling system, effectively reduce the heat of chamber and shaft to ensure long durability and prevent material melting and fusion.
- ≥100HP with advanced self-aligning bearings to ensure excellent lifetime running.
- ≥75HP with cylinder system on feeding hopper and mesh screen, optional for other models as well.
- Suitable for all kinds of large-scale hollow products, leather, PE film, PET bottles.
- Optional for auto collecting and dust separating system for better collecting.



WT-CSR-800V



V type cutter saddle

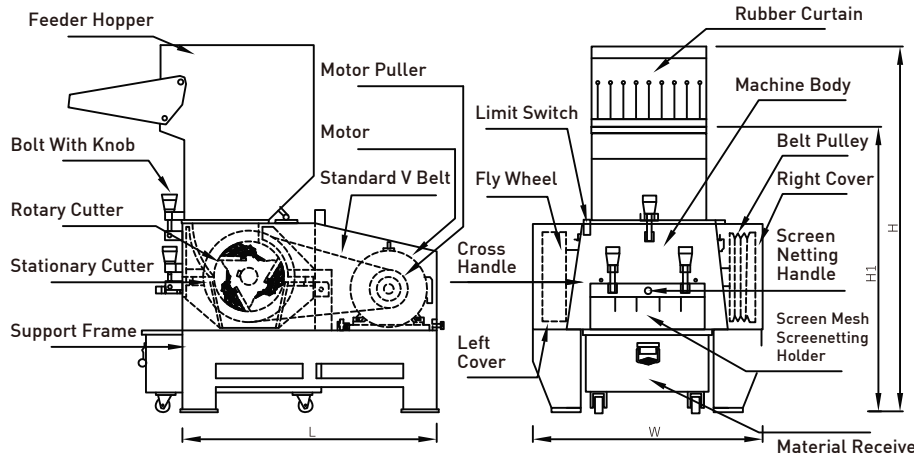

SPECIFICATIONS

Model	WT-CSR-600V / WT-CSR-600V-SP	WT-CSR-800V / WT-CSR-800V-SP	WT-CSR-960V / WT-CSR-960V-SP	WT-CSR-1100V / WT-CSR-1100V-SP
Grinding Chamber (MM)	610x330	815x470	960x610	1100x800
Grinding Capacity (KG/H)	130-230	180-280	230-450	500-800
Stationary Cutter (Piece)	4	4	4	4
Rotary Cutter (Piece)	6	6	6	6
Mesh Size (MM)	Φ10	Φ10	Φ12	Φ12
Power	KW	15	22	37/55
	HP	20	30	50/75
Dimensions (LxWxHxH1) (MM)	1200x1070x1670x1300	1600x1555x2110x1590	2000x1725x2670x2000	2400x2220x3230x2380
Approx. Net Weight (KG)	1100	1840	2600	5500
Dimension for sp (MM)	1940x1080x1980	1850x1540x2680	2050x1850x2860	2420x2120x3230
Collective Blower (KW)	2.2	3	4	7.5
Approx. N. W. for sp (KG)	1150	2250	3500	6500

"SP" stands for soundproof granulator with collecting device.

Note:
The capacities are based on PET water bottles and may differ with other materials.
We reserve the right to change specifications without prior notice.

FLAKE TYPE CRUSHER

FEATURE:

- Flake type blade design, suitable for crushing general plastics like sheets, tube, profiles and packing materials, also runners.
- Feeding hopper with back and front double layered insulation for effective noise handling.
- Blades are made of high-strength alloy tool steel with high hardness, good abrasion resistance and long durability.
- Equipped with multiple safety protection devices to ensure safe operation.
- ≥30HP default with chamber cooling system, effectively reduce the heat of chamber and shaft to ensure long durability and prevent material melting and fusion.
- ≥100HP with advanced self-aligning bearings to ensure excellent lifetime running.
- ≥75HP with cylinder system on feeding hopper and mesh screen, optional for other models as well.
- Optional for auto collecting and dust separating system for better collecting.



WT-CSR-500P



Flake cutter saddle

SPECIFICATIONS

Model	WT-CSR-230P	WT-CSR-300P	WT-CSR-400P	WT-CSR-500P	WT-CSR-600P	WT-CSR-800P	WT-CSR-960P	WT-CSR-1100P	WT-CSR-1200P	
	WT-CSR-230P-SP	WT-CSR-300P-SP	WT-CSR-400P-SP	WT-CSR-500P-SP	WT-CSR-600P-SP	WT-CSR-800P-SP	WT-CSR-960P-SP	WT-CSR-1100P-SP	WT-CSR-1200P-SP	
Grinding Chamber (MM)	230x200	310x200	410x240	510x300	610x330	815x470	960x610	1100x800	1200x800	
Grinding Capacity (KG/H)	100-150	150-200	200-250	300-350	350-450	450-600	800-1000	1000-1200	1000-1500	
Stationary Cutter (Piece)	2	2	2	2	4	4	4	4	4	
Rotary Cutter (Piece)	6	9	12	15	18	24	30	33	36	
Mesh Size (MM)	φ8	φ8	φ8	φ10	φ10	φ10	φ12	φ12	φ12	
Power	KW	4	5.5	7.5	11	15	22/30	37/45/56	75	75
	HP	5	7.5	10	15	20	30/40	50/60/75	100	100
Dimensions (LxWxHxH1) (MM)	800x660x1120x875	920x725x1200x960	980x810x1260x985	1200x970x1570x1230	1200x1070x1670x1230	1600x1555x2110x1590	2000x1725x2670x2000	2420x2120x3230x2380	2420x2220x3230x2380	
Approx. Net Weight (KG)	277	420	500	805	940	2000	3000	6000	6500	
Dimension for sp (MM)	1200x870x1510	1320x840x1580	1350x930x1590x1320	1560x1070x1784x1440	1560x1170x1870x1500	1850x1510x2510x1990	2150x1794x2910x2240	2590x2230x3610x2500	2590x2230x3610x2500	
Collective Blower (KW)	2.2	2.2	2.2	2.2	2.2	3	4/5.5	7.5	7.5	
Approx. N. W. for sp (KG)	400	535	604	1220	1420	2380	3500	6500	6800	

"SP" stands for soundproof granulator with collecting device.

GB SERIES CRUSHER

FEATURE:

- The patented front-positioning blade design is especially for hollow material like bottles and barrels, the special angle and chamber design leading the crushing subject into rotary cutting center, with large cutting angle and ensure even flake output and less powder.
- Feeding hopper with back and front double layered insulation for effective noise handling.
- Blades are made of high-strength alloy tool steel, with high hardness, good abrasion resistance, and long durability.
- Installed with hexagon socket screw, free from wearing lose on screws in long term utility.
- ≥75HP with advanced self-aligning bearings to ensure excellent lifetime running.
- ≥75HP with cylinder system on feeding hopper and mesh screen, optional for other models as well.
- Patented design foot stands with heavy duty capability and low vibration in running.
- Optional for auto collecting and dust separating system for better collecting.



WT-CSR-30GB

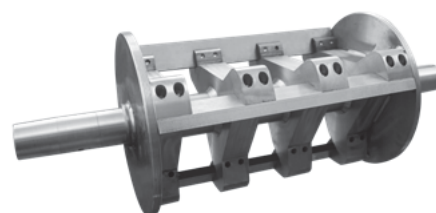
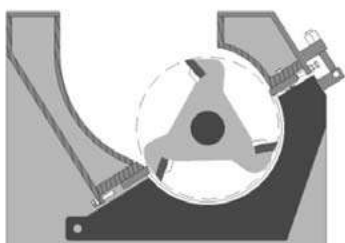

Flake cutter saddle

SPECIFICATIONS

Model		WT-CSR-20GB	WT-CSR-30GB	WT-CSR-50GB	WT-CSR-75GB
Grinding Chamber (MM)		530x400	530x400	830x520	1100x740
Power	KW	15	22	37.5	55
	HP	20	30	50	75
Grinding Capacity (KG)		350-550	400-550	750-1080	800-1200
Stationary Cutter (Piece)		2	2	4	4
Rotary Cutter (Piece)		3	3	6	9
Mesh Size (MM)		Φ14	Φ14	Φ16	Φ16
Barrel Volume (L)		30L	30L	100L	200L
Barrel Size (MM)		Φ330x490	Φ330x490	Φ420x780	Φ600x1000
Dimensions (LxWxHxH1) (MM)		1430x1120x1930x1458	1430x1120x1930x1458	2000x1610x2690x2030	2450x1940x3460x2710

We reserve the right to change specifications without prior notice.
Note: H1 means the height of the ground from the feeding hopper

AUTO COLLECTING SYSTEM

FEATURE:

- Compatible with all series of crushers.
- Auto collecting regrinds from crusher without manual participation.
- Raw materials contact part as plastic hose (or optional for stainless steel) to prevent contamination.
- Dust-collecting devices to store dust and prevent air pollution.
- Easy and fast to disassemble and clean.

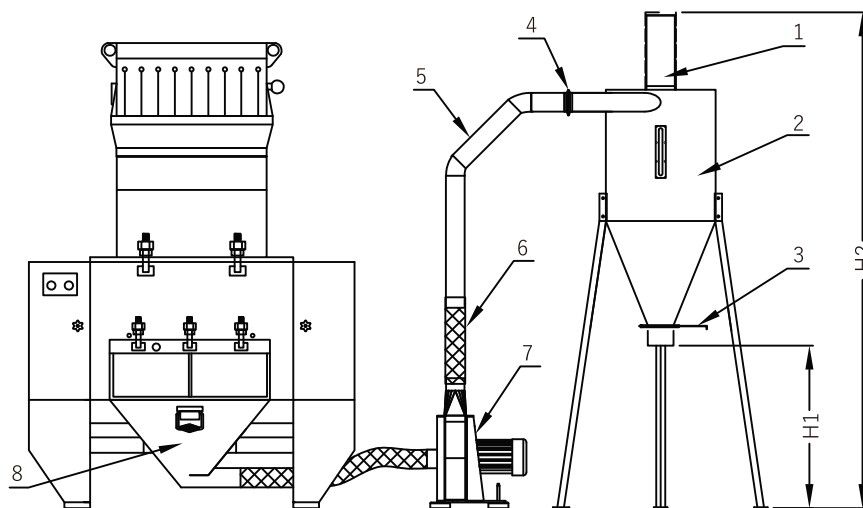

SPECIFICATIONS

Model	WT-RCY-3	WT-RCY-4	WT-RCY-5	WT-RCY-7.5	WT-RCY-10
Motor Power	2.2KW/3HP	3KW/4HP	4KW/5HP	5.5KW/7.5HP	7.5KW/10HP
Loading Pipe Diameter (MM)	Ø89	Ø102	Ø102	Ø127	Ø127
Lift (M)	3	4	5	5	5
Hopper Capacity (KG)	100		200		
Suitable Crusher Model (HP)	5-20	30-40	50	75	100
Height of Collecting Tank (MM)	H1	970	970	1075	1075
	H2	2850	2850	2850	2950

We reserve the right to modify the above information without prior notice.

AUTO POWDER SIFTING DEVICE

FEATURE:

- Compatible with Welltec full series of powerful crushers, and help to automatically separate out the powder from the crushers output.
- Auto conveying--the crushing material will be automatically conveyed to the separator by vacuum suction.
- Auto separation of powder--separating powder through the separator.
- Machine Protection and Dust Removing Function--the powder sifter device could take away the dust on blades and inside grinding chamber.
- Contact part with raw materials as stainless steel, no secondary contamination.
- Suitable for all models of crushers.

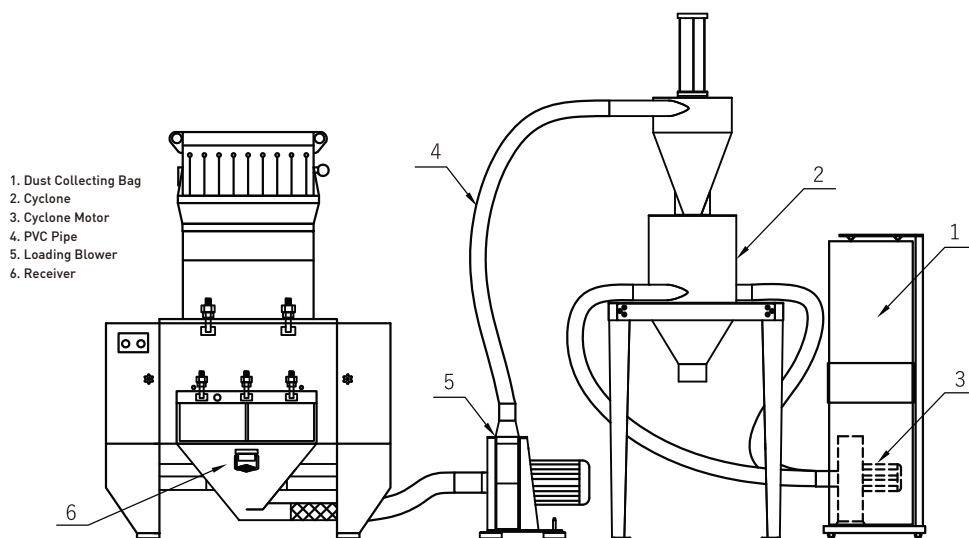

SPECIFICATIONS

Model	WT-PWD-3	WT-PWD-4	WT-PWD-5	WT-PWD-7.5	WT-PWD-10
Collective Blower [HP/KW]	3HP/2.2KW	4HP/3KW	5HP/4KW	7.5HP/5.5KW	10HP/7.5KW
Collective Blower Pipe Diameter (MM)	89	102	102	127	127
Dust Separated Blower [HP/KW]	3HP/2.2KW				
Dust Separated Blower Pipe Diameter (MM)	89				
Models	5HP-20HP	30HP-40HP	50HP	75HP	100HP

We reserve the right to modify the above information without prior notice.

VERTICAL MIXER (STD TYPE)

FEATURE:

- Four-wheel vertical design, small size and easy to move.
- Adopted rubber sealing strip, special slot fixing design.
- Equipped with cycloidal pinwheel reducer motor, low noise and durable.
- Fast complete mixing, low energy consumption and high efficiency.
- Barrel cover and bottom parts are compress formed, precisely matched and durable.
- Mixing time able to be set within 0-30 minutes.



WT-MXR-50

FEATURE VERTICAL PADDLE

Stainless steel paddle with scientific structure, able to mix raw materials completely. Minimize load, save time and electricity. Made of premium stainless steel with high strength and easy to clean.

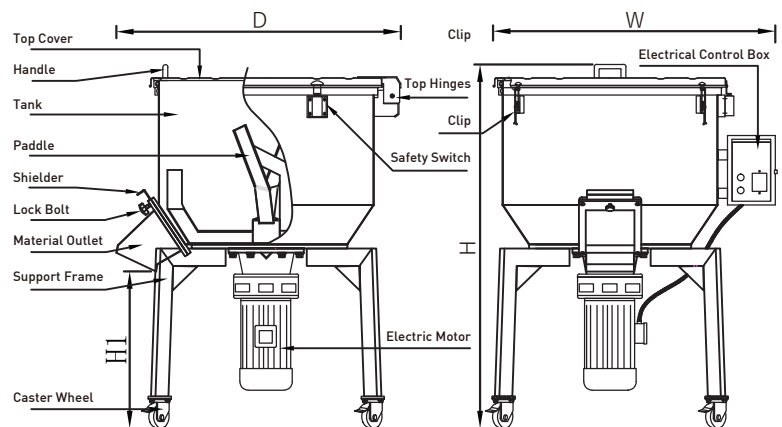

SPECIFICATIONS

Model		WT-MXR-50	WT-MXR-100	WT-MXR-150	WT-MXR-200	WT-MXR-300
Power	KW	1.5	3	4	7.5	7.5
	HP	2	4	5.5	10	10
Capacity (KG)		50	100	150	200	300
Voltage (V)		380 3Φ	380 3Φ	380 3Φ	380 3Φ	380 3Φ
Dimension [WxDxHxH1] (MM)		845x840x1060x450	980x975x1275x540	1125x1105x1420x665	1250x1170x1430x665	1250x1170x1630x665
Rotating Speed (R/MIN)		85	85	85	85	85
Approx. Net Weight (KG)		125	180	270	313	323

We reserve the right to modify the above information without prior notice.

VERTICAL MIXER (EU TYPE)

FEATURE:

- All raw materials contact parts are made of stainless steel to ensure not to be polluted.
- Equipped with vertical screw, materials are being evenly stirring.
- Comprised of easy-disassembly parts(Top Cover, Reducer Motor, Screw and Electrical Control Box), easy for cleaning.
- With auto stop device, stopping time able to be set within 0-30 minutes.
- With main power switch and safety chain protection device to ensure the safety of operator and machine.
- Adopted with height-adjustable expansion bracket and non-slip caster wheels.
- Optional for material outlet with pneumatic valve baffle.
- Optional for installing the suction tube on both sides of the storage tank for easy conveying.



WT-MXR-80-EU

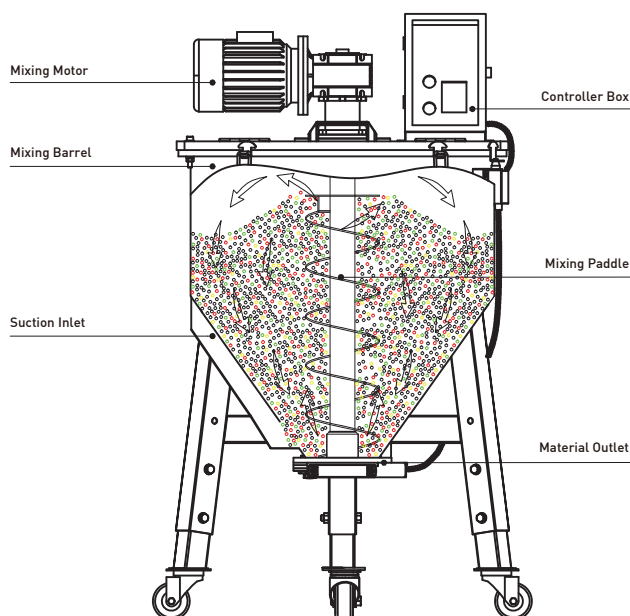

APPLICATION:

Mainly applied in mixture and storage of plastic. Except for mixture and storage of plastic powder raw materials, food, chemicals, inflammable and explosive materials, volatile materials. Bulk specific weight needs to be considered when the size of raw materials are uneven or different shapes.

SPECIFICATIONS

Model	WT-MXR-80-EU	WT-MXR-160-EU	WT-MXR-300-EU
Max Capacity (KG/HR)	200	400	800
Motor Power	0.55	0.75	1.1
Rotating Speed (RPM)	190	190	190
Paddle Diameter (MM)	150	220	250
Dimensions (MM)	1115x955x280x800	1380x1100x230x930	1530x1250x200x1150

We reserve the right to modify the above information without prior notice.

VOLUMETRIC MIXER (DUAL SILOS)

FEATURE:

- SUS barrel part ensures no contamination on raw materials.
- Storage barrel divided as Silo 1 and Silo 2.
- Each hopper could be mounted with vacuum receiver or self-contained loaders.
- Equipped with two sets of volumetric screw dosing device for accuracy of material providing.
- Low noise, high accuracy and high stability.
- Stainless steel screws to ensure raw materials not to be polluted.
- Default with suction box for connection with auto loader.
- Default with level sensor, buzzer and lamp alarm for material shortage alerting.
- Optional for mixing function.

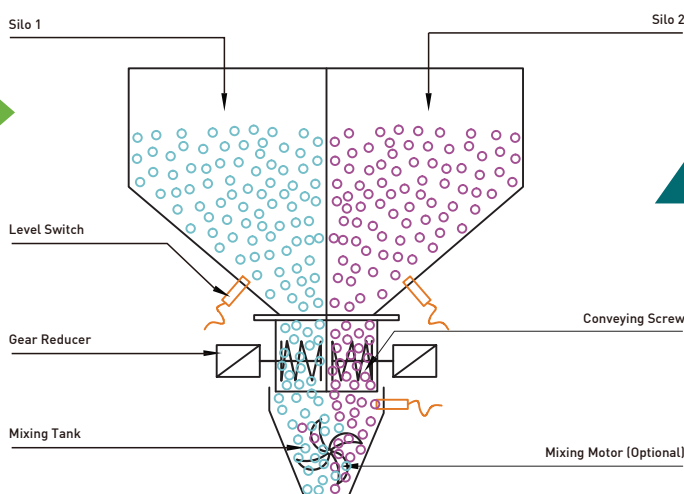

WT-MXR2-50D-160U

APPLICATION:

Mainly used for mixing raw materials and recycled materials in proportion, or mixing two other materials in different proportion.

SPECIFICATIONS

Model	WT-MXR2-50D-160U	WT-MXR2-50D-320U	WT-MXR2-70D-720U	WT-MXR2-70D-1200U
Screw Motor Power [W]	60+60	60+60	90+90	90+90
Mixing Motor Power [W]	90	90	90	90
Screw Diameter [MM]	50	50	70	70
Silo 1 [L]	80	160	360	600
Silo 2 [L]	80	160	360	600
Max Capacity [KG/HR]	480-850	480-850	800-1450	800-1450
Tube Diameter [INCH]	1.5-2.5	1.5-2.5	1.5-2.5	1.5-2.5
Dimensions [WxDxH] [MM]	700x700x1350	800x800x1420	1000x1000x1500	1200x1200x1700

We reserve the right to modify above information without prior notice.

Note:

- 1.The maximum processing capacity is the data obtained from continuous operation test of 1.plastic particles with specific gravity of 0.65 and diameter of 2-3mm.
- 2.Voltage specification: 220V/50Hz/1p.
- 3.Product specifications are subject to change without notice.
- 4.Mixing motor optional.

VOLUMETRIC DOSER (SINGLE / MULTIPLE)

FEATURE:

- Modular and detachable structural design enables quick replacement for screw and sleeve.
- High accuracy hybrid stepping motor to ensure accurate measurement and wide output range.
- Motor drive directly, without gearbox, long service life, maintenance-free.
- PLC touch screen controller with higher and more stable control accuracy.
- Capable of saving 50 recipes of formula and achieve fast booting.
- SUS304 stainless steel screw with much durability.
- Metering part can be removed from the base as a whole without material leakage. The side of the base has a window device for easy observation of the raw materials.

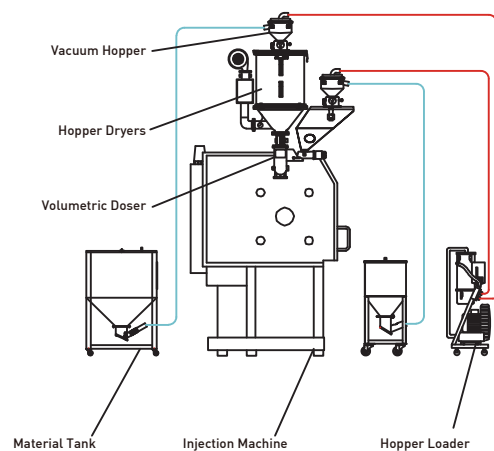
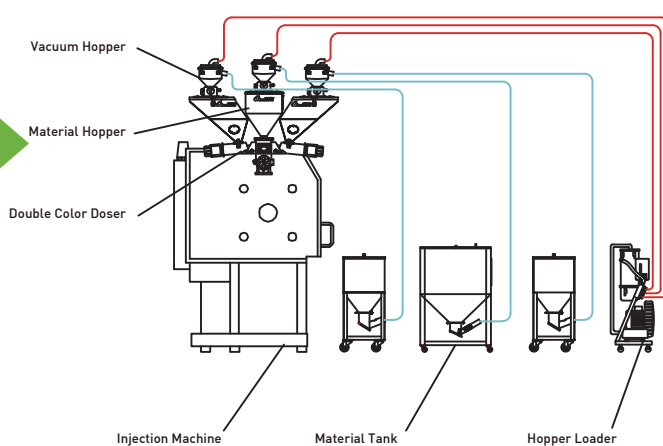

SPECIFICATIONS

Model	Single Color Unit			Double Color Unit	Three Color Unit
	WT-DSR-12	WT-DSR-14	WT-DSR-16	WT-DSRII	WT-DSRIII
Motor Power [KW]	0.3	0.3	0.3	0.3x2	0.3x3
Rotary Speed (R.P.M.)	1.8~300	1.8~300	1.8~300	1.8~300	1.8~300
Mixer Power [KW]	0.09	0.09	0.09	0.09	0.09
Screw Dia. (MM)	12	14	16	**	**
Output Capacity (KG/HR)	0.05~20	0.1~40	0.5~64	*	*
Storage Capacity (L)	13	13	13	13	13
Main Material Hopper (L)	Optional	Optional	Optional	Optional	Optional
Mixer	Optional	Optional	Optional	Optional	Optional
Dimensions (HxWxD) (MM)	430x560x300	430x560x300	430x560x300	430x960x300	520x1050x1050
Approx. Net Weight (KG)	25	25	25	45	75

Note:
 1. "*" means the output capacity depends on the screw selected, data of the single color doser can be a reference.
 2. "**" stands for external diameter of screw is up to model selected.
 3. Single color doser with screw, add "MX" on the back of model.
 4. The output proportion of all models are 1.2, diameter 2 ~ 3mm masterbatch in a test criteria of continuous running.
 5. Voltage : 1Φ, 230V, 50Hz.

We reserve the right to modify the above information without prior notice.

GRAVIMETRIC BLENDER

FEATURE:

- Modular and detachable structure design to save space and for easy-cleaning.
- PLC touch screen controller with higher and more stable control accuracy.
- Advanced control algorithm, self-optimization, auto adjustment compensation and vibration prevention to ensure the best batching accuracy.
- The standard model can handle 4 components. Models with more than 6 components can be customized.
- Color graphic display, touch screen operation, multiple languages for selection.
- With formula saving function for more than 100 formulas.
- Classified security password control and alarm history.
- USB2.0 interface for saving recipe data to flash disk, facilitate the quality management.
- With sound and light alarm, the operator can quickly reach the faulty site.
- All raw materials contact parts are made of stainless steel to ensure not to be polluted.
- Optional for machine mounted or stand frame installation(including pneumatic discharge valve).



WT-GBD-400

Machine Mount

WT-GBD-400

Stand Frame Installation

SPECIFICATIONS

Model	WT-GBD-50	WT-GBD-100	WT-GBD-200	WT-GBD-400	WT-GBD-600	WT-GBD-800	WT-GBD-1200	WT-GBD-2000	WT-GBD-2500	WT-GBD-3000
QTY of Group Number	4	4	4	4	4	4	4	4	4	4
Mixing Capacity (KG/HR)	50	100	200	400	600	800	1200	2000	2500	3000
Batch Weight (KG)	1	3	3.5	8	10	12	15	20	30	30
Main Material Mixing Range (%)	5-100	5-100	5-100	5-100	5-100	5-100	5-100	5-100	5-100	5-100
Additive Mixing Range (%)	0.5-10	0.5-10	0.5-10	0.5-10	0.5-10	0.5-10	0.5-10	0.5-10	0.5-10	0.5-10
Main Hopper Volume (L)	18	25	32	45	70	100	130	160	180	230
Additive Hopper Volume (L)	5	8	12	15	18	25	30	40	50	70
Mixing Barrel Volume (L)	8	10	10	18	25	25	30	40	60	60
Power Supply (V/Hz)	1Φ 230/50	1Φ 230/50	1Φ 230/50	3Φ 400/50	3Φ 400/50	3Φ 400/50	3Φ 400/50	3Φ 400/50	3Φ 400/50	3Φ 400/50
Total Power (KW)	0.12	0.12	0.25	0.55	0.55	0.55	1.5	1.5	1.5	3
Compressed Air (KGF/CM2)	6-8	6-8	6-8	6-8	6-8	6-8	6-8	6-8	6-8	6-8
Max. Noise Level (dB)	<75	<75	<75	<75	<75	<75	<75	<75	<75	<75
Dimensions (HxWxD) (MM)	1560x710x560	1725x925x700	1745x825x750	2070x800x700	2170x800x700	2200x1060x1070	2370x1060x1160	2190x1310x1260	2190x1310x1260	2350x1350x1470
Base (H2xW2xD2) (W3xD3-ΦC) (MM)	130x130-Φ80	200x375x275 130x130-Φ100	200x375x275 130x130-Φ100	210x450x350 150x150-Φ100	210x450x350 150x150-Φ100					
Mobile Stand (H1xW1xD1) (MM)	600x675x540	660x675x560	660x675x560	760x750x580	760x750x580	760x900x650	760x900x650	1100x1200x900	1100x1200x900	1150x1200x915
NW (KG) [Machine Installation]	90	90	130	140	180	200	250	280	290	380
NW (KG) [Stand Frame Installation]	110	110	155	165	230	250	340	370	380	500

Note:

1. Dosing accuracy are refer to each ingredient accuracy.

2. Standard valves are not suitable for powder dosing.

3. Maximum output of each model and dosing accuracy are based on the data from bulk density 0.8, diameter 3-4mm pellets in a test criteria of continuous running.
We reserve the right to modify the above information without prior notice.

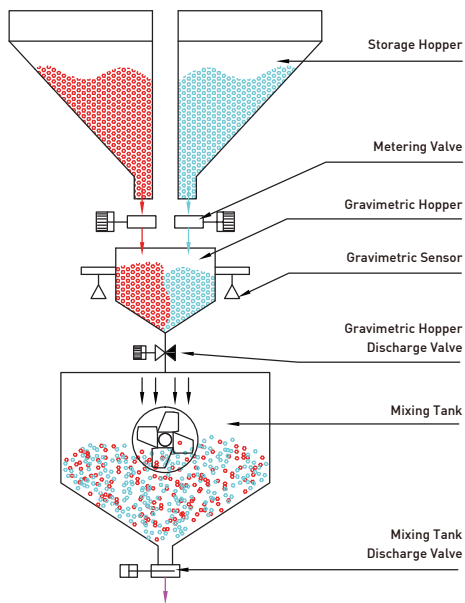

OPTIONS:

- Hopper low material level alarm switch.
- Automatic loading control module.
- Pneumatic slide gate(Suitable for machine mount model).
- Floor stand, pneumatic slide gate, storage bin and suction box should be optionally purchased for floor mounting.
- Ethernet interface, MODBUS, PROFIBUS communication module, which can realize remote monitoring, or with extruder, injection molding machine to transfer data.

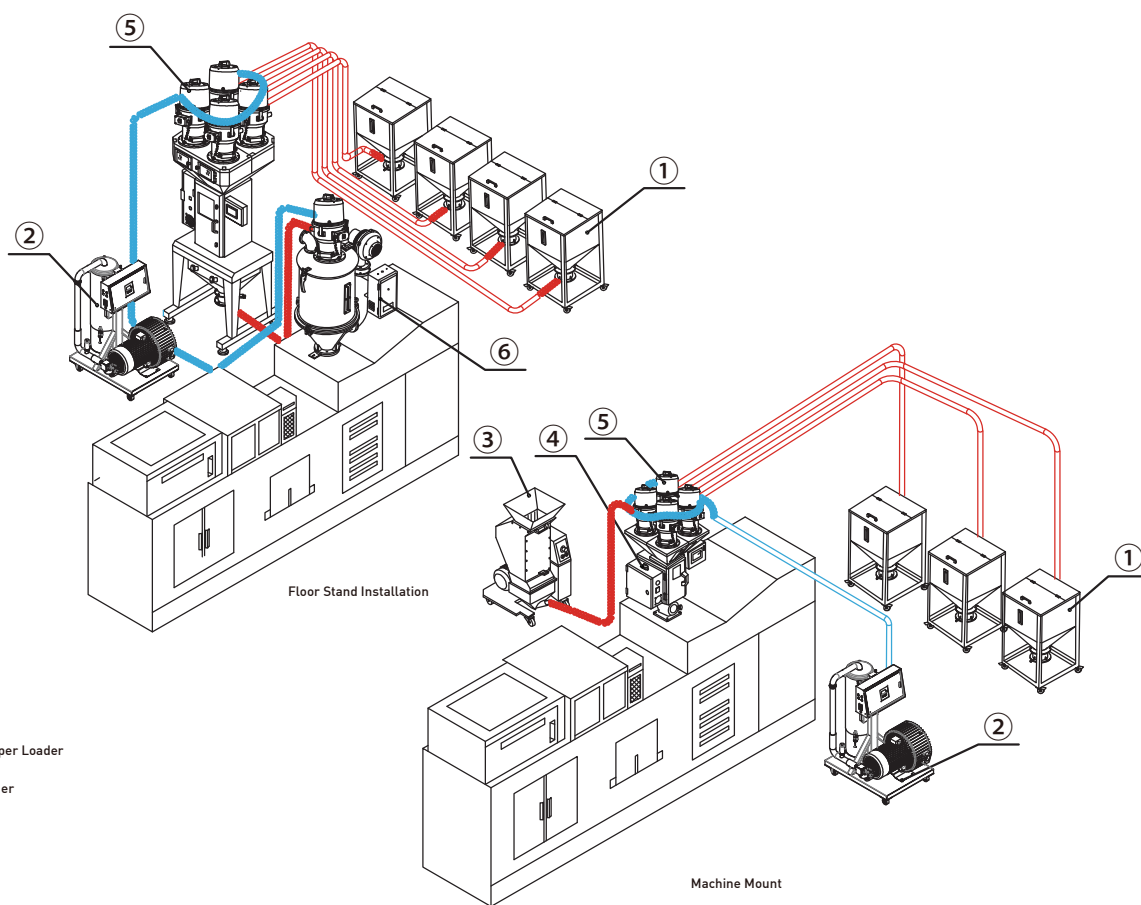

1. Material Tank
2. Multi-Station Hopper Loader
3. Online Granulator
4. Gravimetric Blender
5. Vacuum Hopper
6. Hopper Dryer

VERTICAL BLENDER

FEATURE:

- Helical circular mixture, fast and evenly stirring.
- Suitable for mixing masterbatch with all kinds of plastic raw materials and even better with new and grinded materials.
- Fully stainless steel contacting parts, rust free and easy to clean.
- Equipped with power control device to ensure safety.
- With heating and drying function for option: double layer thermal insulation Euro heating hopper design to reduce heat loss. With low surface temperature, equipped with over-temperature trip protection function, energy-saving and safe. Medium-pressure blower with large air volume.



WT-VBD-3000

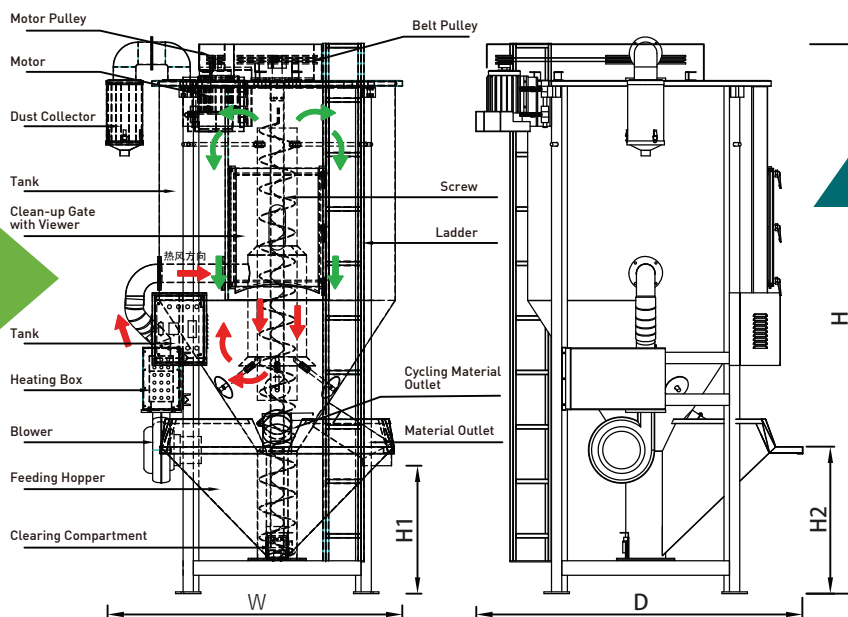

SPECIFICATIONS

Model		WT-VBD-500	WT-VBD-1000	WT-VBD-2000	WT-VBD-3000	WT-VBD-5000
Power	KW	2.2	3	4	5.5	7.5
	HP	3	4	5	7.5	10
Capacity (KG)		500	1000	2000	3000	5000
Voltage (V)		380 3Φ	380 3Φ	380 3Φ	380 3Φ	380 3Φ
Dimension (WxDxHxH1) (MM)		1210x1480x2425x520	1636x1800x3070x705	1930x2035x3650x680	2375x2420x3670x700	2375x2420x3670x700
Height of Hopper H2 (MM)		660	810	825	845	845
Rotating Speed (R/MIN)		300	300	300	300	300
Heating Power (KW)		12	18	30	38	38
Blower (W)		0.32	1	1.5	2.2	2.2
Approx. Net Weight (KG)		450	630	1050	1250	1500

We reserve the right to modify the above information without prior notice.



ЕВРОПОЛИМЕР ТРЕЙДИНГ

Адрес: Ростов-на-Дону, ул. Вавилова 59

Тел: +7 (863) 309-03-88

Сайт: <https://tpa-ept.ru/>

Email: tpa@ep-group.ru